

---

---

**UNITED STATES  
SECURITIES AND EXCHANGE COMMISSION**  
Washington, D.C. 20549

---

**FORM 10-Q**

---

(Mark One)

**QUARTERLY REPORT PURSUANT TO SECTION 13 OR 15(d) OF THE SECURITIES EXCHANGE ACT OF 1934**

For the quarterly period ended June 30, 2015

OR

**TRANSITION REPORT PURSUANT TO SECTION 13 OR 15(d) OF THE SECURITIES EXCHANGE ACT OF 1934**

For the transition period from \_\_\_\_\_ to \_\_\_\_\_

Commission File Number: 001-35784

**NORWEGIAN CRUISE LINE HOLDINGS LTD.**

(Exact name of registrant as specified in its charter)

Bermuda  
(State or other jurisdiction of  
incorporation or organization)

98-0691007  
(I.R.S. Employer  
Identification No.)

7665 Corporate Center Drive, Miami, Florida 33126  
(Address of principal executive offices) (zip code)

(305) 436-4000  
(Registrant's telephone number, including area code)

N/A  
(Former name, former address and former fiscal year, if changed since last report)

Indicate by check mark whether the registrant (1) has filed all reports required to be filed by Section 13 or 15(d) of the Securities Exchange Act of 1934 during the preceding 12 months (or for such shorter period that the registrant was required to file such reports), and (2) has been subject to such filing requirements for the past 90 days. Yes  No

Indicate by check mark whether the registrant has submitted electronically and posted on its corporate Web site, if any, every Interactive Data File required to be submitted and posted pursuant to Rule 405 of Regulation S-T (§232.405 of this chapter) during the preceding 12 months (or for such shorter period that the registrant was required to submit and post such files). Yes  No

Indicate by check mark whether the registrant is a large accelerated filer, an accelerated filer, a non-accelerated filer, or a smaller reporting company (See the definitions of "large accelerated filer," "accelerated filer" and "smaller reporting company" in Rule 12b-2 of the Exchange Act).

Large accelerated filer	<input checked="" type="checkbox"/>	Accelerated filer	<input type="checkbox"/>
Non-accelerated filer	<input type="checkbox"/> (Do not check if a smaller reporting company)	Smaller reporting company	<input type="checkbox"/>

Indicate by check mark whether the registrant is a shell company (as defined in Rule 12b-2 of the Exchange Act). Yes  No

There were 229,147,263 ordinary shares outstanding as of July 31, 2015.

---

---

## TABLE OF CONTENTS

	<u>Page</u>
<b><u>PART I. FINANCIAL INFORMATION</u></b>	
<u>Item 1. Financial Statements</u>	1
<u>Item 2. Management's Discussion and Analysis of Financial Condition and Results of Operations</u>	17
<u>Item 3. Quantitative and Qualitative Disclosures About Market Risk</u>	29
<u>Item 4. Controls and Procedures</u>	30
<b><u>PART II. OTHER INFORMATION</u></b>	
<u>Item 1. Legal Proceedings</u>	31
<u>Item 1A. Risk Factors</u>	31
<u>Item 2. Unregistered Sales of Equity Securities and Use of Proceeds</u>	31
<u>Item 6. Exhibits</u>	31
<b><u>SIGNATURES</u></b>	<b>33</b>

---

PART I. FINANCIAL INFORMATION

Item 1. Financial Statements

**Norwegian Cruise Line Holdings Ltd.**  
**Consolidated Statements of Operations**  
**(Unaudited)**  
(in thousands, except share and per share data)

	Three Months Ended June 30,		Six Months Ended June 30,	
	2015	2014	2015	2014
<b>Revenue</b>				
Passenger ticket	\$ 787,991	\$ 528,782	\$ 1,458,474	\$ 977,362
Onboard and other	297,442	237,145	565,141	452,593
Total revenue	<u>1,085,433</u>	<u>765,927</u>	<u>2,023,615</u>	<u>1,429,955</u>
<b>Cruise operating expense</b>				
Commissions, transportation and other	192,438	114,712	364,265	231,522
Onboard and other	67,885	55,467	126,530	103,391
Payroll and related	161,930	106,352	319,559	205,418
Fuel	91,581	77,832	178,955	156,872
Food	43,699	42,734	85,550	80,417
Other	98,746	73,699	205,120	139,086
Total cruise operating expense	<u>656,279</u>	<u>470,796</u>	<u>1,279,979</u>	<u>916,706</u>
<b>Other operating expense</b>				
Marketing, general and administrative	107,164	83,084	261,321	166,473
Depreciation and amortization	104,607	63,459	204,583	125,099
Total other operating expense	<u>211,771</u>	<u>146,543</u>	<u>465,904</u>	<u>291,572</u>
Operating income	<u>217,383</u>	<u>148,588</u>	<u>277,732</u>	<u>221,677</u>
<b>Non-operating income (expense)</b>				
Interest expense, net	(52,446)	(31,860)	(103,435)	(63,032)
Other income (expense)	(3,717)	(325)	(33,856)	63
Total non-operating income (expense)	<u>(56,163)</u>	<u>(32,185)</u>	<u>(137,291)</u>	<u>(62,969)</u>
<b>Net income before income taxes</b>	161,220	116,403	140,441	158,708
<b>Income tax benefit (expense)</b>	<u>(2,726)</u>	<u>(3,124)</u>	<u>(3,403)</u>	<u>6,263</u>
<b>Net income</b>	158,494	113,279	137,038	164,971
<b>Net income attributable to non-controlling interest</b>	—	1,663	—	2,088
<b>Net income attributable to Norwegian Cruise Line Holdings Ltd.</b>	<u>\$ 158,494</u>	<u>\$ 111,616</u>	<u>\$ 137,038</u>	<u>\$ 162,883</u>
<b>Weighted-average shares outstanding</b>				
Basic	225,698,078	204,965,718	225,003,460	205,063,870
Diluted	<u>230,228,144</u>	<u>210,472,991</u>	<u>229,664,210</u>	<u>210,742,655</u>
<b>Earnings per share</b>				
Basic	\$ 0.70	\$ 0.54	\$ 0.61	\$ 0.79
Diluted	<u>\$ 0.69</u>	<u>\$ 0.54</u>	<u>\$ 0.60</u>	<u>\$ 0.78</u>

The accompanying notes are an integral part of these consolidated financial statements.

**Norwegian Cruise Line Holdings Ltd.**  
**Consolidated Statements of Comprehensive Income**  
**(Unaudited)**  
**(in thousands)**

	<u>Three Months Ended</u> <u>June 30,</u>		<u>Six Months Ended</u> <u>June 30,</u>	
	<u>2015</u>	<u>2014</u>	<u>2015</u>	<u>2014</u>
Net income	\$ 158,494	\$ 113,279	\$ 137,038	\$ 164,971
Other comprehensive income (loss):				
Shipboard Retirement Plan	120	95	239	189
Cash flow hedges:				
Net unrealized income (loss)	70,491	8,797	(33,274)	(6,559)
Amount realized and reclassified into earnings	26,564	(147)	48,450	6
Total other comprehensive income (loss)	97,175	8,745	15,415	(6,364)
Total comprehensive income	255,669	122,024	152,453	158,607
Comprehensive income attributable to non-controlling interest	—	1,757	—	2,045
Total comprehensive income attributable to Norwegian Cruise Line Holdings Ltd.	<u>\$ 255,669</u>	<u>\$ 120,267</u>	<u>\$ 152,453</u>	<u>\$ 156,562</u>

The accompanying notes are an integral part of these consolidated financial statements.

**Norwegian Cruise Line Holdings Ltd.**  
**Consolidated Balance Sheets**  
**(Unaudited)**  
**(in thousands, except share data)**

	<b>June 30, 2015</b>	<b>December 31, 2014</b>
<b>Assets</b>		
Current assets:		
Cash and cash equivalents	\$ 172,958	\$ 84,824
Accounts receivable, net	36,801	32,432
Inventories	59,801	56,555
Prepaid expenses and other assets	130,357	109,924
Total current assets	399,917	283,735
Property and equipment, net	8,674,815	8,623,773
Goodwill	1,388,931	1,388,931
Intangible assets	958,394	994,997
Other long-term assets	265,330	281,641
Total assets	<u>\$ 11,687,387</u>	<u>\$ 11,573,077</u>
<b>Liabilities and Shareholders' Equity</b>		
Current liabilities:		
Current portion of long-term debt	\$ 585,875	\$ 576,947
Accounts payable	55,061	101,983
Accrued expenses and other liabilities	581,216	552,514
Due to Affiliate	38,737	37,948
Advance ticket sales	1,213,199	817,207
Total current liabilities	2,474,088	2,086,599
Long-term debt	5,178,044	5,607,157
Due to Affiliate	—	18,544
Other long-term liabilities	294,800	341,964
Total liabilities	7,946,932	8,054,264
Commitments and contingencies (Note 9)		
Shareholders' equity:		
Ordinary shares, \$.001 par value; 490,000,000 shares authorized; 232,281,275 shares issued and 229,128,505 shares outstanding at June 30, 2015 and 230,116,780 shares issued and 227,630,430 shares outstanding at December 31, 2014	232	230
Additional paid-in capital	3,771,531	3,702,344
Accumulated other comprehensive income (loss)	(227,227)	(242,642)
Retained earnings	277,919	140,881
Treasury shares (3,152,770 and 2,486,350 ordinary shares at June 30, 2015 and December 31, 2014, respectively, at cost)	(82,000)	(82,000)
Total shareholders' equity	3,740,455	3,518,813
Total liabilities and shareholders' equity	<u>\$ 11,687,387</u>	<u>\$ 11,573,077</u>

The accompanying notes are an integral part of these consolidated financial statements.

**Norwegian Cruise Line Holdings Ltd.**  
**Consolidated Statements of Cash Flows**  
**(Unaudited)**  
**(in thousands)**

	Six Months Ended June 30,	
	2015	2014
<b>Cash flows from operating activities</b>		
Net income	\$ 137,038	\$ 164,971
Adjustments to reconcile net income to net cash provided by operating activities:		
Depreciation and amortization expense	214,717	141,228
Loss (gain) on derivatives	27,475	(62)
Deferred income taxes, net	424	2,786
Contingent consideration	(43,400)	—
Write-off of deferred financing fees	195	—
Share-based compensation expense	14,166	5,079
Changes in operating assets and liabilities:		
Accounts receivable, net	(4,369)	(8,885)
Inventories	(3,246)	(8,851)
Prepaid expenses and other assets	(15,472)	(8,943)
Accounts payable	(47,038)	15,967
Accrued expenses and other liabilities	(949)	20,905
Advance ticket sales	412,602	194,913
Net cash provided by operating activities	<u>692,143</u>	<u>519,108</u>
<b>Cash flows from investing activities</b>		
Additions to property and equipment	(186,504)	(787,566)
Net cash used in investing activities	<u>(186,504)</u>	<u>(787,566)</u>
<b>Cash flows from financing activities</b>		
Repayments of long-term debt	(791,403)	(540,237)
Repayments to Affiliate	(18,522)	(18,521)
Proceeds from long-term debt	340,060	914,545
Proceeds from the exercise of share options	55,023	2,158
Purchases of treasury shares	—	(79,155)
NCLC partnership tax distributions	—	(3,115)
Deferred financing fees and other	(2,663)	(201)
Net cash provided by (used in) financing activities	<u>(417,505)</u>	<u>275,474</u>
Net increase in cash and cash equivalents	88,134	7,016
Cash and cash equivalents at beginning of period	84,824	56,467
Cash and cash equivalents at end of period	<u>\$ 172,958</u>	<u>\$ 63,483</u>

The accompanying notes are an integral part of these consolidated financial statements.

**Norwegian Cruise Line Holdings Ltd.**  
**Consolidated Statements of Changes in Shareholders' Equity**  
**(Unaudited)**  
**(in thousands)**

	Ordinary Shares	Additional Paid-in Capital	Accumulated Other Comprehensive Income (Loss)	Retained Earnings (Deficit)	Treasury Shares	Non-controlling Interest	Total Shareholders' Equity
<b>Balance, December 31, 2013</b>	\$ 205	\$ 2,822,864	\$ (16,690)	\$ (197,471)	\$ —	\$ 22,358	\$ 2,631,266
Share-based compensation	—	5,079	—	—	—	—	5,079
Transactions with Affiliates, net	—	(59)	—	—	—	—	(59)
NCLC partnership tax distributions	—	—	—	—	—	(3,115)	(3,115)
Proceeds from the exercise of share options	—	2,158	—	—	—	—	2,158
Purchases of treasury shares	—	—	—	—	(79,155)	—	(79,155)
Other comprehensive loss	—	—	(6,321)	—	—	(43)	(6,364)
Net income	—	—	—	162,883	—	2,088	164,971
Transfers to non-controlling interest	—	(7,834)	—	—	—	7,834	—
<b>Balance, June 30, 2014</b>	<u>\$ 205</u>	<u>\$ 2,822,208</u>	<u>\$ (23,011)</u>	<u>\$ (34,588)</u>	<u>\$ (79,155)</u>	<u>\$ 29,122</u>	<u>\$ 2,714,781</u>
<b>Balance, December 31, 2014</b>	\$ 230	\$ 3,702,344	\$ (242,642)	\$ 140,881	\$ (82,000)	\$ —	\$ 3,518,813
Share-based compensation	—	14,166	—	—	—	—	14,166
Proceeds from the exercise of share options	2	55,021	—	—	—	—	55,023
Other comprehensive income	—	—	15,415	—	—	—	15,415
Net income	—	—	—	137,038	—	—	137,038
<b>Balance, June 30, 2015</b>	<u>\$ 232</u>	<u>\$ 3,771,531</u>	<u>\$ (227,227)</u>	<u>\$ 277,919</u>	<u>\$ (82,000)</u>	<u>\$ —</u>	<u>\$ 3,740,455</u>

The accompanying notes are an integral part of these consolidated financial statements.

**Norwegian Cruise Line Holdings Ltd.**

**Notes to Consolidated Financial Statements  
(Unaudited)**

Unless otherwise indicated or the context otherwise requires, references in this report to (i) the “Company,” “we,” “our” and “us” refer to NCLH (as defined below) and its subsidiaries (including Prestige (as defined below), except for periods prior to the consummation of the Acquisition of Prestige (as defined below)), (ii) “NCLC” refers to NCL Corporation Ltd., (iii) “NCLH” refers to Norwegian Cruise Line Holdings Ltd., (iv) “Norwegian” refers to the Norwegian Cruise Line brand and its predecessors, (v) “Prestige” refers to Prestige Cruises International, Inc., together with its consolidated subsidiaries, (vi) “PCH” refers to Prestige Cruise Holdings, Inc., Prestige’s direct wholly owned subsidiary, which in turn is the parent of Oceania Cruises, Inc. (“Oceania”) and Seven Seas Cruises S. DE R.L. (“Regent”) (Oceania also refers to the brand Oceania Cruises and Regent also refers to the brand Regent Seven Seas Cruises), (vii) “Apollo” refers to Apollo Global Management, LLC, its subsidiaries and the affiliated funds it manages and the “Apollo Holders” refers to one or more of AIF VI NCL (AIV), L.P., AIF VI NCL (AIV II), L.P., AIF VI NCL (AIV III), L.P., AIF VI NCL (AIV IV), L.P., AAA Guarantor — Co-Invest VI (B), L.P., Apollo Overseas Partners (Delaware) VI, L.P., Apollo Overseas Partners (Delaware 892) VI, L.P., Apollo Overseas Partners VI, L.P., Apollo Overseas Partners (Germany) VI, L.P., AAA Guarantor — Co-Invest VII, L.P., AIF VI Euro Holdings, L.P., AIF VII Euro Holdings, L.P., Apollo Alternative Assets, L.P., Apollo Management VI, L.P. and Apollo Management VII, L.P., (viii) “TPG Global” refers to TPG Global, LLC, “TPG” refers to TPG Global and its affiliates and the “TPG Viking Funds” refers to one or more of TPG Viking, L.P., TPG Viking AIV I, L.P., TPG Viking AIV II, L.P., and TPG Viking AIV-III, L.P. and/or certain other affiliated investment funds, each an affiliate of TPG, (ix) “Genting HK” refers to Genting Hong Kong Limited and/or its affiliates (formerly Star Cruises Limited and/or its affiliates) (Genting HK owns NCLH’s ordinary shares indirectly through Star NCLC Holdings Ltd., its wholly owned subsidiary (“Star NCLC”)), and (x) “Affiliate(s)” or “Sponsor(s)” refers to the Apollo Holders, Genting HK and/or the TPG Viking Funds.

**1. Corporate Reorganization**

In February 2011, NCLH, a Bermuda limited company, was formed with the issuance to the Sponsors of, in aggregate, 10,000 ordinary shares, with a par value of \$.001 per share. On January 24, 2013, NCLH consummated its initial public offering (“IPO”). In connection with the consummation of the IPO, the Sponsors’ ordinary shares in NCLC were exchanged for the ordinary shares of NCLH at a share exchange ratio of 1.0 to 8.42565 and NCLH became the owner of 100% of the ordinary shares and parent company of NCLC (the “Corporate Reorganization”). Accordingly, NCLH contributed \$460.0 million to NCLC and the historical financial statements of NCLC became those of NCLH. The Corporate Reorganization was effected solely for the purpose of reorganizing our corporate structure. NCLH had not prior to the completion of the Corporate Reorganization conducted any activities other than those incidental to its formation and to preparations for the Corporate Reorganization and IPO. The Corporate Reorganization resulted in all parties being in the same economic position as they were immediately prior to the IPO. As the economic position of the investors did not change as part of the Corporate Reorganization it is considered a nonsubstantive merger from an accounting perspective.

As a result of the Corporate Reorganization, NCLC was treated as a partnership for U.S. federal income tax purposes, and the terms of the partnership (including the economic rights with respect thereto) are set forth in an amended and restated tax agreement for NCLC. Economic interests in NCLC were represented by the partnership interests established under the tax agreement, which we refer to as “NCL Corporation Units.” The NCL Corporation Units held by NCLH (as a result of its ownership of 100% of the ordinary shares of NCLC) represented a 97.3% economic interest in NCLC as of the consummation of the IPO. The remaining 2.7% economic interest in NCLC as of the consummation of the IPO was in the form of Management NCL Corporation Units held by management (or former management).

In the fourth quarter of 2014, all Management NCL Corporation Units were exchanged for NCLH ordinary shares and restricted ordinary shares. NCLH became the sole member and 100% owner of the economic interests in NCLC and the non-controlling interest no longer exists. Accordingly, NCLC is now treated as a disregarded entity for U.S. federal income tax purposes. No new NCLC profits interests or Management NCL Corporation Units will be issued; however, NCLH has granted, and expects to continue to grant to our management team, options to acquire its ordinary shares under its long-term incentive plan.

**2. Summary of Significant Accounting Policies**

**Basis of Presentation**

The accompanying consolidated financial statements are unaudited and, in our opinion, contain all normal recurring adjustments necessary for a fair statement of the results for the periods presented.

Our operations are seasonal and results for interim periods are not necessarily indicative of the results for the entire fiscal year. Historically, demand for cruises has been strongest during the summer months. The interim consolidated financial statements should be read in conjunction with the audited consolidated financial statements for the year ended December 31, 2014, which are included in our most recently filed Annual Report on Form 10-K.

During the three months ended June 30, 2015, we revised for the year ended December 31, 2014, the classification of goodwill and intangible assets to separately present goodwill and intangible assets, net. The revision was not deemed material to the Consolidated Balance Sheet.



**Reclassification**

Certain amounts in prior periods have been reclassified to conform to the current period presentation.

**Shareholders' Equity**

In connection with the Corporate Reorganization, previously granted profits interests to employees were exchanged for Management NCL Corporation Units ("Units"), and the vested Unit holders gained proportionate rights to distributions of NCLC and were therefore allocated a proportionate share of NCLC's equity. The effect of this change was a \$20.2 million increase in the non-controlling interest.

During the six months ended June 30, 2014, following the effectiveness of NCLH's registration statement on Form S-3, additional performance-based Units became eligible to participate in the earnings of NCLC, and as a result, a proportionate amount of NCLC's equity was allocated to the additional non-controlling interest. Each Unit holder had the right, subject to the same time-based and performance-based vesting requirements of the profits interests, to exchange Units for NCLH's ordinary shares at a rate equal to one ordinary share for every Unit. When such an exchange occurred, this resulted in the exchange of non-controlling interest to controlling interest. Accordingly, upon the exchange of a Unit for an ordinary share of NCLH, a portion of the non-controlling interest balance was reclassified to additional paid-in capital. As of June 30, 2014, there was \$7.8 million transferred to non-controlling interest.

As of June 30, 2014, Management NCL Corporation Unit holders were distributed cash to facilitate partnership tax payments of \$3.1 million and \$2.8 million of these distributions were subsequently repaid to NCLC upon exchange of each Unit holders' Units. In the fourth quarter of 2014, all Management NCL Corporation Units were exchanged for NCLH ordinary shares and restricted ordinary shares. We refer you to Note 1— "Corporate Reorganization".

On April 29, 2014, NCLH's Board of Directors authorized, and NCLH announced, a three-year share repurchase program for up to \$500.0 million. NCLH may make repurchases in the open market, in privately negotiated transactions, in accelerated repurchase programs or in structured share repurchase programs, and any repurchases may be made pursuant to Rule 10b5-1 plans. During the three months ended June 30, 2014, NCLH repurchased approximately 2.4 million ordinary shares under its share repurchase program for \$79.2 million, which shares are reflected as treasury shares at cost on the consolidated balance sheet as of June 30, 2014 included in NCLH's Quarterly Report on Form 10-Q filed on July 31, 2014. There was no share repurchase activity during the three and six months ended June 30, 2015, and as of June 30, 2015, \$418.0 million remained available for repurchases of our outstanding ordinary shares under the share repurchase program. The increase in treasury shares reported in NCLH's consolidated balance sheets as of June 30, 2015 relates to certain forfeitures of restricted ordinary shares held by management or former management of NCLH.

**Earnings Per Share**

A reconciliation between basic and diluted earnings per share was as follows (in thousands, except share and per share data):

	Three Months Ended June 30,		Six Months Ended June 30,	
	2015	2014	2015	2014
Net income attributable to Norwegian Cruise Line Holdings Ltd.	\$ 158,494	\$ 111,616	\$ 137,038	\$ 162,883
Net income	\$ 158,494	\$ 113,279	\$ 137,038	\$ 164,971
Basic weighted-average shares outstanding	225,698,078	204,965,718	225,003,460	205,063,870
Dilutive effect of share awards	4,530,066	5,507,273	4,660,750	5,678,785
Diluted weighted-average shares outstanding	230,228,144	210,472,991	229,664,210	210,742,655
Basic earnings per share	\$ 0.70	\$ 0.54	\$ 0.61	\$ 0.79
Diluted earnings per share	\$ 0.69	\$ 0.54	\$ 0.60	\$ 0.78

**Revenue and Expense Recognition**

Revenue and expense includes taxes assessed by governmental authorities that are directly imposed on a revenue-producing transaction between a seller and a customer. The amounts included in revenue and expense on a gross basis were \$62.4 million and

\$44.6 million for the three months ended June 30, 2015 and 2014, respectively, and \$114.3 million and \$82.5 million for the six months ended June 30, 2015 and 2014, respectively.

Guest cancellation penalties are recognized in passenger ticket revenue at the time of the cancellation.

### **Recently Issued Accounting Pronouncements**

In May 2014, the Financial Accounting Standards Board (“FASB”) issued ASU No. 2014-09, “Revenue from Contracts with Customers.” ASU No. 2014-09 requires entities to recognize revenue through the application of a five-step model, which includes identification of the contract, identification of the performance obligations, determination of the transaction price, allocation of the transaction price to the performance obligation and recognition of revenue as the entity satisfies the performance obligations. Entities have the option of using either a full retrospective or a modified approach to adopt the guidance. The FASB approved a one-year deferral of the effective date. We can elect to adopt the provisions of ASU No. 2014-09 for annual periods beginning after December 15, 2017 including interim periods within that reporting period or we can elect to early adopt the guidance as of the original effective date. We are currently evaluating the impact of the adoption of this newly issued guidance to our consolidated financial statements.

In April 2015, the FASB issued ASU No. 2015-03 which was issued to simplify the presentation of debt issuance costs. The guidance requires that debt issuance costs related to a recognized debt liability be presented in the balance sheet as a direct deduction from the carrying amount of that debt liability, consistent with debt discounts. The recognition and measurement guidance for debt issuance costs are not affected by these amendments. This guidance should be applied on a retrospective basis, wherein the balance sheet of each individual period presented should be adjusted to reflect the period-specific effects of applying the new guidance. The guidance will be effective for financial statements issued for fiscal years beginning after December 15, 2015, and interim periods within those fiscal years. Early adoption is permitted for financial statements that have not been previously issued. We are currently evaluating the impact of the adoption of this newly issued guidance to our consolidated financial statements.

In April 2015, the FASB issued ASU No. 2015-05 which was issued to clarify a customer’s accounting for fees paid in a cloud computing arrangement. The amendments provide guidance to customers about whether a cloud computing arrangement includes a software license or if the arrangement should be accounted for as a service contract. This guidance will impact the accounting of software licenses but will not change a customer’s accounting for service contracts. The guidance will be effective for annual periods, including interim periods within those annual periods, beginning after December 15, 2015. Early adoption is permitted. An entity can elect to adopt the amendments either prospectively or retrospectively. We are currently evaluating the impact, if any, of the adoption of this newly issued guidance to our consolidated financial statements.

### **3. The Acquisition of Prestige**

On November 19, 2014, we completed the Acquisition of Prestige. Consideration for the Acquisition of Prestige includes a cash payment of up to \$50 million upon achievement of certain 2015 net revenue milestones. The contingent consideration is valued using various projected 2015 net revenue scenarios weighted by the likelihood of each scenario occurring. The probability-weighted payout is then discounted at an appropriate discount rate commensurate for the risk of meeting the probabilistic cash flows. As the fair value is measured based upon significant inputs that are unobservable in the market, it was classified as Level 3 in the fair value hierarchy. Level 3 consists of significant unobservable inputs we believe market participants would use in pricing the asset or liability based on the best information available. The significant unobservable inputs used in the fair value measurement of the Company’s contingent consideration are the estimated annual net revenue and the probabilities associated with attaining the threshold and target net revenue as defined by the Merger Agreement. A significant increase in the estimated net revenue or an increase in the probability associated with reaching the target would result in a significantly higher fair value measurement. The maximum fair value would not be able to exceed \$50 million, while an amount of net revenue less than 98% of target would result in no payout. For the six months ended June 30, 2015, the fair value of the contingent consideration was reduced to zero based upon updates to the probability-weighted assessment of various projected revenue scenarios. We do not believe that the net revenue target will be met, and accordingly, we recognized a \$43.4 million fair value adjustment in the six months ended June 30, 2015, which was included in marketing, general and administrative expense.

[Table of Contents](#)

The following table summarizes the change in fair value of the contingent consideration liability (in thousands):

	<b>Contingent Consideration Liability</b>
Balance as of December 31, 2014	\$ 43,400
Fair value adjustment (Level 3)	(43,400)
Balance as of June 30, 2015	<u>\$ —</u>

**4. Accumulated Other Comprehensive Income (Loss)**

Accumulated other comprehensive income (loss) for the six months ended June 30, 2015 was as follows (in thousands):

	<b>Accumulated Other Comprehensive Income (Loss)</b>	<b>Change Related to Cash Flow Hedges</b>	<b>Change Related to Shipboard Retirement Plan</b>
Accumulated other comprehensive income (loss) at beginning of period	\$ (242,642)	\$ (234,188)	\$ (8,454)
Current period other comprehensive loss before reclassifications	(33,274)	(33,274)	—
Amounts reclassified into earnings	48,689	48,450(1)	239(2)
Accumulated other comprehensive income (loss) at end of period	<u>\$ (227,227)</u>	<u>\$ (219,012)(3)</u>	<u>\$ (8,215)</u>

- (1) We refer you to Note 7—“Fair Value Measurements and Derivatives” for the affected line items in the Consolidated Statements of Operations.  
(2) Amortization of prior-service cost and actuarial loss reclassified to payroll and related expense.  
(3) Includes \$63.0 million of losses expected to be reclassified into earnings in the next 12 months.

Accumulated other comprehensive income (loss) for the six months ended June 30, 2014 was as follows (in thousands):

	<b>Accumulated Other Comprehensive Income (Loss)</b>	<b>Change Related to Cash Flow Hedges</b>	<b>Change Related to Shipboard Retirement Plan</b>
Accumulated other comprehensive income (loss) at beginning of period	\$ (16,690)	\$ (10,532)	\$ (6,158)
Current period other comprehensive loss before reclassifications	(6,515)	(6,515)	—
Amounts reclassified into earnings	194	6(1)	188(2)
Accumulated other comprehensive income (loss) at end of period	<u>\$ (23,011)</u>	<u>\$ (17,041)</u>	<u>\$ (5,970)</u>

- (1) We refer you to Note 7—“Fair Value Measurements and Derivatives” for the affected line items in the Consolidated Statements of Operations.  
(2) Amortization of prior-service cost and actuarial loss reclassified to payroll and related expense.

**5. Related Party Disclosures**

In May 2015, the Selling Shareholders sold 20,000,000 ordinary shares of NCLH in a Secondary Equity Offering. In March 2015, Genting HK and the TPG Viking Funds sold 12,500,000 ordinary shares of NCLH in a Secondary Equity Offering. The Company did not receive any proceeds from these offerings. As of June 30, 2015, the relative ownership percentages of NCLH’s ordinary shares were as follows: Genting HK (17.7%), the Apollo Holders (20.6%), the TPG Viking Funds (3.2%), and public shareholders (58.5%).

In March 2015, we entered into an agreement with SWB Yankees, LLC related to sponsorship of and advertising with the Scranton/Wilkes-Barre RailRiders, a Minor League Baseball team. Pursuant to the agreement, we will pay an annual fee to SWB Yankees, LLC of \$200,000. Mr. David M. Abrams, one of our directors, is the co-managing partner of the Scranton/Wilkes-Barre RailRiders.

**6. Income Tax Benefit (Expense)**

NCLH is treated as a corporation for U.S. federal income tax purposes. For the three months ended June 30, 2015, we had an income tax expense of \$2.7 million compared to \$3.1 million for the three months ended June 30, 2014. For the six months ended June 30, 2015 we had an income tax expense of \$3.4 million compared to an income tax benefit of \$6.3 million for the six months ended June 30, 2014. The benefit for 2014 includes a \$6.7 million non-recurring benefit associated with the election of a tax method to calculate deductible interest expense.

## 7. Fair Value Measurements and Derivatives

Fair value is defined as the price at which an orderly transaction to sell an asset or to transfer a liability would take place between market participants at the measurement date under current market conditions (that is, an exit price at the measurement date from the perspective of a market participant that holds the asset or owes the liability).

### Fair Value Hierarchy

The following hierarchy for inputs used in measuring fair value should maximize the use of observable inputs and minimize the use of unobservable inputs by requiring that the most observable inputs be used when available:

- Level 1 Quoted prices in active markets for identical assets or liabilities that are accessible at the measurement dates.
- Level 2 Significant other observable inputs that are used by market participants in pricing the asset or liability based on market data obtained from independent sources.
- Level 3 Significant unobservable inputs we believe market participants would use in pricing the asset or liability based on the best information available.

### Derivatives

We are exposed to market risk attributable to changes in interest rates, foreign currency exchange rates and fuel prices. We attempt to minimize these risks through a combination of our normal operating and financing activities and through the use of derivatives. We assess whether derivatives used in hedging transactions are “highly effective” in offsetting changes in the cash flow of our hedged forecasted transactions. We use regression analysis for this hedge relationship and high effectiveness is achieved when a statistically valid relationship reflects a high degree of offset and correlation between the fair values of the derivative and the hedged forecasted transaction. Cash flows from the derivatives are classified in the same category as the cash flows from the underlying hedged transaction. The determination of ineffectiveness is based on the amount of dollar offset between the cumulative change in fair value of the derivative and the cumulative change in fair value of the hedged transaction at the end of the reporting period. If it is determined that a derivative is not highly effective as a hedge, or if the hedged forecasted transaction is no longer probable of occurring, then the amount recognized in accumulated other comprehensive income (loss) is released to earnings. In addition, the ineffective portion of our highly effective hedges is recognized in earnings immediately and reported in other income (expense) in our consolidated statements of operations. There are no amounts excluded from the assessment of hedge effectiveness and there are no credit-risk-related contingent features in our derivative agreements.

We monitor concentrations of credit risk associated with financial and other institutions with which we conduct significant business. Credit risk, including but not limited to counterparty non-performance under derivatives and our revolving credit facility, is not considered significant, as we primarily conduct business with large, well-established financial institutions that we have established relationships with and that have credit risks acceptable to us or the credit risk is spread out among a large number of creditors. We do not anticipate non-performance by any of our significant counterparties.

The following table sets forth our derivatives measured at fair value and discloses the balance sheet location (in thousands):

	Balance Sheet location	Asset		Liability	
		June 30, 2015	December 31, 2014	June 30, 2015	December 31, 2014
<b>Fuel swaps designated as hedging instruments</b>					
	Accrued expenses and other liabilities	\$ 1,744	\$ —	\$ 52,407	\$ 111,304
	Other long-term liabilities	1,075	190	44,419	77,250
<b>Fuel swaps not designated as hedging instruments</b>					
	Accrued expenses and other liabilities	—	—	18,319	—
<b>Foreign currency forward contracts designated as hedging instruments</b>					
	Prepaid expenses and other assets	3,077	—	—	—
	Other long-term assets	1,730	—	—	—
	Accrued expenses and other liabilities	—	—	84,588	29,498
	Other long-term liabilities	—	—	11,330	118
<b>Foreign currency forward contracts not designated as hedging instruments</b>					
	Prepaid expenses and other assets	99	—	—	—
<b>Foreign currency collar not designated as a hedging instrument</b>					
	Other long-term liabilities	—	—	36,347	16,744
<b>Interest rate swaps designated as hedging instruments</b>					
	Accrued expenses and other liabilities	—	—	6,100	5,736
	Other long-term liabilities	—	—	4,114	3,104
<b>Interest rate swap not designated as a hedging instrument</b>					
	Accrued expenses and other liabilities	—	—	—	3,823

[Table of Contents](#)

The fair values of swap and forward contracts are determined based on inputs that are readily available in public markets or can be derived from information available in publicly quoted markets. The Company determines the value of options and collars utilizing an option pricing model based on inputs that are either readily available in public markets or can be derived from information available in publicly quoted markets. The option pricing model used by the Company is an industry standard model for valuing options and is used by the broker/dealer community. The inputs to this option pricing model are the option strike price, underlying price, risk free rate of interest, time to expiration, and volatility. The fair value of option contracts considers both the intrinsic value and any remaining time value associated with those derivatives that have not yet settled. The Company also considers counterparty credit risk and its own credit risk in its determination of all estimated fair values. Our derivatives and financial instruments were categorized as Level 2 in the fair value hierarchy, and we had no derivatives or financial instruments categorized as Level 1 or Level 3 as of June 30, 2015 and December 31, 2014.

Our derivative contracts include rights of offset with our counterparties. We have elected to net certain assets and liabilities within counterparties. We are not required to post cash collateral related to our derivative instruments. The following table discloses the amounts recognized within the consolidated balance sheets (in thousands):

	<b>Gross Amounts</b>	<b>Gross Amounts Offset</b>	<b>Total Net Amounts</b>	<b>Gross Amounts Not Offset</b>	<b>Net Amounts</b>
<b>June 30, 2015</b>					
Assets	\$ 4,906	\$ —	\$ 4,906	\$ (4,906)	\$ —
Liabilities	257,624	(2,819)	254,805	(142,479)	112,326
<b>December 31, 2014</b>					
Liabilities	\$ 247,577	\$ (190)	\$ 247,387	\$ (59,023)	\$ 188,364

**Fuel Swaps**

As of June 30, 2015, we had fuel swaps maturing through December 31, 2018 which are used to mitigate the financial impact of volatility in fuel prices pertaining to approximately 1.1 million metric tons of our projected fuel purchases.

The effects on the consolidated financial statements of the fuel swaps which were designated as cash flow hedges were as follows (in thousands):

	<b>Three Months Ended June 30,</b>		<b>Six Months Ended June 30,</b>	
	<b>2015</b>	<b>2014</b>	<b>2015</b>	<b>2014</b>
Gain recognized in other comprehensive income (loss) – effective portion	\$ 34,133	\$ 11,610	\$ 31,332	\$ 1,839
Gain (loss) recognized in other income (expense) – ineffective portion	(3,194)	451	(9,245)	35
Amount reclassified from accumulated other comprehensive income (loss) into fuel expense	15,297	(1,218)	35,833	(1,923)

[Table of Contents](#)

As of June 30, 2015, we had fuel swaps pertaining to approximately 100,000 metric tons which were not designated as cash flow hedges. These fuel swaps were previously designated as cash flow hedges and were dedesignated due to a change in our expected future fuel purchases mix.

The effects on the consolidated financial statements of the fuel swaps which were dedesignated and immediately recognized into earnings were as follows (in thousands):

	Three Months Ended June 30,		Six Months Ended June 30,	
	2015	2014	2015	2014
Amount reclassified from accumulated other comprehensive income (loss) into other income (expense)	\$ 10,000	\$ —	\$ 10,000	\$ —

**Fuel Collars and Options**

We had fuel collars and fuel options maturing through December 2014, which were used to mitigate the financial impact of volatility in fuel prices of our fuel purchases.

The effects on the consolidated financial statements of the fuel collars which were designated as cash flow hedges were as follows (in thousands):

	Three Months Ended June 30,		Six Months Ended June 30,	
	2015	2014	2015	2014
Gain (loss) recognized in other comprehensive income (loss) – effective portion	\$ —	\$ 15	\$ —	\$ (309)
Gain (loss) recognized in other income (expense) – ineffective portion	—	(1)	—	107
Amount reclassified from accumulated other comprehensive income (loss) into fuel expense	10	371	248	741

The effects on the consolidated financial statements of the fuel options which were not designated as hedging instruments were as follows (in thousands):

	Three Months Ended June 30,		Six Months Ended June 30,	
	2015	2014	2015	2014
Gain recognized in other income (expense)	\$ —	\$ 101	\$ —	\$ 186

**Foreign Currency Options**

We had foreign currency options that matured through January 2014, which consisted of call options with deferred premiums. These options were used to mitigate the financial impact of volatility in foreign currency exchange rates related to our ship construction contracts denominated in euros. If the spot rate at the date the ships were delivered was less than the strike price under these option contracts, we would have paid the deferred premium and would not exercise the foreign currency options.

The effects on the consolidated financial statements of the foreign currency options which were designated as cash flow hedges were as follows (in thousands):

	Three Months Ended June 30,		Six Months Ended June 30,	
	2015	2014	2015	2014
Loss recognized in other comprehensive income (loss) – effective portion	\$ —	\$ —	\$ —	\$ (1,157)
Loss recognized in other income (expense) – ineffective portion	—	—	—	(241)
Amount reclassified from accumulated other comprehensive income (loss) into depreciation and amortization expense	330	329	660	608

**Foreign Currency Forward Contracts**

As of June 30, 2015, we had foreign currency forward contracts which were used to mitigate the financial impact of volatility in foreign currency exchange rates related to our ship construction contracts and forecasted Dry-dock payments denominated in euros. The notional amount of our foreign currency forward contracts was €0.9 billion, or \$1.0 billion based on the euro/U.S. dollar exchange rate as of June 30, 2015.

The effects on the consolidated financial statements of the foreign currency forward contracts which were designated as cash flow hedges were as follows (in thousands):

	Three Months Ended June 30,		Six Months Ended June 30,	
	2015	2014	2015	2014
Gain (loss) recognized in other comprehensive income (loss) – effective portion	\$ 36,928	\$ 88	\$ (60,447)	\$ (988)
Gain (loss) recognized in other income (expense) – ineffective portion	8	—	(7)	(1)
Amount reclassified from accumulated other comprehensive income (loss) into depreciation and amortization expense	(63)	(64)	(127)	(117)

As of June 30, 2015, we had a foreign currency forward contract related to a foreign currency financial instrument denominated in Norwegian kroner (“NOK”) which is an economic hedge. The notional amount of our foreign currency forward contract was NOK 124.8 million, or \$15.9 million based on the NOK/U.S. dollar exchange rate as of June 30, 2015.

The effects on the consolidated financial statements of the foreign currency forward contract which was not designated as a cash flow hedge was as follows (in thousands):

	Three Months Ended June 30,		Six Months Ended June 30,	
	2015	2014	2015	2014
Gain recognized in other income (expense)	\$ 99	\$ —	\$ 99	\$ —

**Foreign Currency Collar**

We had a foreign currency collar that matured in January 2014, which was used to mitigate the volatility of foreign currency exchange rates related to our ship construction contracts denominated in euros.

The effects on the consolidated financial statements of the foreign currency collar which was designated as a cash flow hedge was as follows (in thousands):

	Three Months Ended June 30,		Six Months Ended June 30,	
	2015	2014	2015	2014
Loss recognized in other comprehensive income (loss) – effective portion	\$ —	\$ —	\$ —	\$ (1,588)
Amount reclassified from accumulated other comprehensive income (loss) into depreciation and amortization expense	(91)	(91)	(182)	(151)

As of June 30, 2015, we had a foreign currency collar which was used to mitigate the financial impact of volatility in foreign currency exchange rates related to a ship construction contract. The notional amount of our foreign currency collar was €274.4 million, or \$305.9 million based on the euro/U.S. dollar exchange rate as of June 30, 2015.

The effect on the consolidated financial statements of the foreign currency collar contract which was not designated as a cash flow hedge was as follows (in thousands):

	Three Months Ended June 30,		Six Months Ended June 30,	
	2015	2014	2015	2014
Gain (loss) recognized in other income (expense)	\$ 9,350	\$ —	\$ (19,603)	\$ —

### Interest Rate Swaps

As of June 30, 2015, we had interest rate swap agreements to mitigate our exposure to interest rate movements and to manage our interest expense. The notional amount of outstanding debt associated with the interest rate swap agreements was \$1.2 billion.

The effects on the consolidated financial statements of the interest rates swaps which were designated as cash flow hedges were as follows (in thousands):

	Three Months Ended June 30,		Six Months Ended June 30,	
	2015	2014	2015	2014
Loss recognized in other comprehensive income (loss) – effective portion	\$ (570)	\$ (2,916)	\$ (4,159)	\$ (4,356)
Loss recognized in other income (expense) – ineffective portion	(5)	—	(12)	—
Amount reclassified from accumulated other comprehensive income (loss) into interest expense, net	1,081	526	2,018	848

We had an interest rate swap that matured in January 2015, which was used to mitigate our exposure to interest rate movements and to manage our interest expense.

The effect on the consolidated financial statements of the interest rate swap which was not designated as a cash flow hedge was as follows (in thousands):

	Three Months Ended June 30,		Six Months Ended June 30,	
	2015	2014	2015	2014
Loss recognized in other income (expense)	\$ —	\$ —	\$ (2)	\$ —

### Long-Term Debt

As of June 30, 2015 and December 31, 2014, the fair value of our long-term debt, including the current portion, was \$5,812.0 million and \$6,229.1 million, which was \$48.9 million and \$45.0 million higher, respectively, than the carrying values. The difference between the fair value and carrying value of our long-term debt is due to our fixed and variable rate debt obligations carrying interest rates that are above or below market rates at the measurement dates. The fair value of our long-term debt was calculated based on estimated rates for the same or similar instruments with similar terms and remaining maturities. The calculation of the fair value of our long-term debt is considered a Level 2 input.

### Other

The carrying amounts reported in the consolidated balance sheets of all financial assets and liabilities other than our long-term debt approximate fair value.



## 8. Employee Benefits and Share Option Plans

### Share Option Awards

The following is a summary of option activity under our share option plan for the six months ended June 30, 2015:

	Number of Share Option Awards		Weighted-Average Exercise Price		Weighted-Average Contractual Term (years)	Aggregate Intrinsic Value (in thousands)
	Time-Based Awards	Performance-Based Awards	Time-Based Awards	Performance-Based Awards		
Outstanding as of January 1, 2015	6,079,881	1,457,314	\$ 29.92	\$ 19.00	7.61	\$ 142,831
Granted	250,000	—	47.67	—		
Exercised	(1,799,944)	(341,300)	26.97	19.00		
Forfeited and cancelled	(819,137)	(477,611)	31.99	19.00		
Outstanding as of June 30, 2015	<u>3,710,800</u>	<u>638,403</u>	<u>32.09</u>	<u>19.00</u>	<u>7.61</u>	<u>112,508</u>

The total intrinsic value of options exercised during the three and six months ended June 30, 2015 was \$4.7 million and \$49.5 million, respectively, and total cash received by the Company from options exercised was \$3.2 million and \$55.0 million for the three and six months ended June 30, 2015, respectively. Share-based compensation expense for the three months ended June 30, 2015 was \$2.2 million and for the six months ended June 30, 2015 was \$14.2 million, which includes \$8.2 million related to the acceleration of certain equity awards of the former President and Chief Executive Officer, and was recorded in marketing, general and administrative expense.

On July 1, 2015, we granted approximately 3.4 million share option awards to our employees at an exercise price of \$56.19 with a contractual term of ten years. On August 4, 2015, we granted to our employees approximately 689.0 thousand share option awards at an exercise price of \$59.43 with a contractual term of ten years. The share option awards vest equally over three years. In addition, on August 4, 2015, we entered into an amendment to the employment agreement with our President and Chief Executive Officer pursuant to which we granted 625.0 thousand time-based share option awards and 625.0 thousand performance-based share option awards at an exercise price of \$59.43 with a contractual term of ten years. The time-based share option awards vest 50% on June 30, 2017 and 50% on June 30, 2019. The performance-based share option awards vest upon certain hurdles being achieved. We also granted to our President and Chief Executive Officer 150.0 thousand restricted share units which ratably vest over four years through June 30, 2019 and 150.0 thousand performance-based restricted share units which vest upon certain hurdles being achieved.

### Restricted Ordinary Share Awards

The following is a summary of restricted ordinary share activity for the six months ended June 30, 2015:

	Number of Time-Based Awards	Weighted-Average Grant Date Fair Value	Number of Performance-Based Awards	Weighted-Average Grant Date Fair Value
Non-vested as of January 1, 2015	196,644	\$ 3.43	1,208,608	\$ 3.37
Granted	4,815	46.70	—	—
Vested	(26,059)	10.38	(56,687)	4.13
Forfeited or Expired	(73,476)	2.68	(587,869)	2.79
Non-vested and expected to vest as of June 30, 2015	<u>101,924</u>	<u>4.24</u>	<u>564,052</u>	<u>3.90</u>

### Other Employee Matters

On January 8, 2015, Kevin M. Sheehan resigned as President and Chief Executive Officer of the Company, together with all of his positions and offices with the Company and its subsidiaries or affiliates, effective immediately. In connection with Mr. Sheehan's resignation from the Company, Mr. Sheehan and the Company entered into a Separation Agreement and Release (the "Separation Agreement"). The Separation Agreement sets forth the terms of Mr. Sheehan's resignation from the Company, including, among other things, a general release of claims in favor of the Company and certain non-competition, non-solicitation, confidentiality and cooperation undertakings. The Separation Agreement also provides that Mr. Sheehan will receive (i) all of his accrued and unpaid base salary (and accrued and unpaid vacation time) through January 8, 2015 (the "Effective Date"), (ii) his previously approved bonus payment for fiscal year 2014 of \$1,627,500, (iii) a one-time cash separation payment in an amount equal to his base salary and target bonus and (iv) vesting of a portion of his outstanding unvested equity-based awards as of the Effective Date, and all remaining unvested equity-based awards shall immediately terminate, expire and be forfeited as of the Effective Date. This resulted in a total severance expense of \$13.4 million of which \$8.2 million was due to the acceleration of the equity-based awards which was recorded in marketing, general and administrative expense in January 2015.

Effective as of January 8, 2015, Frank J. Del Rio was appointed President and Chief Executive Officer of the Company.

## 9. Commitments and Contingencies

### Ship Construction Contracts

We have four Breakaway Plus Class Ships on order with Meyer Werft shipyard for delivery in the fall of 2015, spring of 2017, spring of 2018 and fall of 2019. These ships will be the largest in our fleet, reaching approximately 164,600 Gross Tons and up to 4,200 Berths each and will be similar in design and innovation to our Breakaway Class Ships. The combined contract price of these four ships is approximately €3.1 billion, or \$3.5 billion based on the euro/U.S. dollar exchange rate as of June 30, 2015. We have export credit financing in place that provides financing for 80% of their contract prices. We also have a contract with Fincantieri shipyard to build a luxury cruise ship to be named Seven Seas Explorer. The contract price of the ship is approximately €343.0 million, or approximately \$382.3 million based on the euro/U.S. dollar exchange rate as of June 30, 2015. We have export credit financing in place that provides financing for 80% of the ship's contract price. Seven Seas Explorer is expected to be delivered in the summer of 2016.

In connection with the contracts to build the ships, we do not anticipate any contractual breaches or cancellation to occur. However, if any would occur, it could result in, among other things, the forfeiture of prior deposits or payments made by us and potential claims and impairment losses which may materially impact our business, financial condition and results of operations.

### Litigation

In 2015, the Alaska Department of Environmental Conservation issued Notices of Violations to major cruise lines that operated in the state of Alaska, including Norwegian, for alleged violations of the Alaska Marine Vessel Visible Emission Standards that occurred over the last several years. We are cooperating with the state of Alaska and conducting our own internal investigation into these matters. However, we do not believe the ultimate outcome will have a material impact on our financial condition, results of operations or cash flows.

In the normal course of our business, various claims and lawsuits have been filed or are pending against us. Most of these claims and lawsuits are covered by insurance and, accordingly, the maximum amount of our liability is typically limited to our deductible amount. Nonetheless, the ultimate outcome of these claims and lawsuits that are not covered by insurance cannot be determined at this time. We have evaluated our overall exposure with respect to all of our threatened and pending litigation and, to the extent required, we have accrued amounts for all estimable probable losses associated with our deemed exposure. We are currently unable to estimate any other potential contingent losses beyond those accrued, as discovery is not complete nor is adequate information available to estimate such range of loss or potential recovery. We intend to vigorously defend our legal position on all claims and, to the extent necessary, seek recovery.

## 10. Restructuring Costs

Due to the Acquisition of Prestige, a number of employee positions were consolidated. As of June 30, 2015, we had an accrual balance of \$7.2 million for restructuring costs for severance and other employee-related costs. The expense of \$11.2 million for the six months ended June 30, 2015 is included in marketing general and administrative expense.

The following table summarizes changes in the accrual for restructuring costs (in thousands):

	<b>Restructuring costs</b>
Accrued expense balance as of December 31, 2014	\$ (7,956)
Amounts paid	11,991
Additional accrued expense	(11,244)
Accrued expense balance as of June 30, 2015	<u>\$ (7,209)</u>

## 11. Supplemental Cash Flow Information

For the six months ended June 30, 2015, we had non-cash investing activities in connection with a capital lease of \$27.6 million.

## 12. Revision to the Consolidated Statement of Cash Flows

During the three months ended June 30, 2015, we determined that for the year ended December 31, 2014, non-cash transactions related to the financing of one of our ships was reported as cash used for additions to property and equipment and cash provided by proceeds from long-term debt. The Consolidated Statement of Cash Flows, for the year ended December 31, 2014, will be revised in our Form 10-K for the year ending December 31, 2015, by decreasing cash used for additions to property and equipment and cash provided by proceeds from long-term debt by \$82.0 million. We have determined that the revision is not material to our consolidated financial statements.

## Item 2. Management's Discussion and Analysis of Financial Condition and Results of Operations

### Cautionary Statement Concerning Forward-Looking Statements

Certain statements in this report constitute forward-looking statements within the meaning of the U.S. federal securities laws intended to qualify for the safe harbor from liability established by the Private Securities Litigation Reform Act of 1995. All statements other than statements of historical facts contained, or incorporated by reference, in this report, including, without limitation, those regarding our business strategy, financial position, results of operations, plans, prospects and objectives of management for future operations (including development plans and objectives relating to our activities), are forward-looking statements. Many, but not all, of these statements can be found by looking for words like "expect," "anticipate," "goal," "project," "plan," "believe," "seek," "will," "may," "forecast," "estimate," "intend" and "future" and similar words. Forward-looking statements do not guarantee future performance and may involve risks, uncertainties and other factors which could cause our actual results, performance or achievements to differ materially from the future results, performance or achievements expressed or implied in those forward-looking statements. Examples of these risks, uncertainties and other factors include, but are not limited to:

- the effects of costs incurred in connection with the Acquisition of Prestige;
- the ability to realize, or delays in realizing, the anticipated benefits of the Acquisition of Prestige;
- the assumption of certain potential liabilities relating to Prestige's business;
- the diversion of management's attention away from operations as a result of the integration of Prestige's business;
- the effect that the Acquisition of Prestige may have on employee relations and on our ability to retain key personnel;
- the adverse impact of general economic conditions and related factors, such as fluctuating or increasing levels of unemployment, underemployment and the volatility of fuel prices, declines in the securities and real estate markets, and perceptions of these conditions that decrease the level of disposable income of consumers or consumer confidence;
- the risks associated with operating internationally, including changes in interest rates and/or foreign currency exchange rates;
- changes in fuel prices and/or other cruise operating costs;
- the impact of our hedging strategies;
- our efforts to expand our business into new markets;
- our substantial indebtedness, including the ability to raise additional capital to fund our operations, and to generate the necessary amount of cash to service our existing debt;
- restrictions in the agreements governing our indebtedness that limit our flexibility in operating our business;
- the significant portion of our assets pledged as collateral under our existing debt agreements and the ability of our creditors to accelerate the repayment of our indebtedness;
- our ability to incur significantly more debt despite our substantial existing indebtedness;
- the impact of volatility and disruptions in the global credit and financial markets, which may adversely affect our ability to borrow and could increase our counterparty credit risks, including those under our credit facilities, derivatives, contingent obligations, insurance contracts and new ship progress payment guarantees;
- adverse events impacting the security of travel, such as terrorist acts, acts of piracy, armed conflict and threats thereof and other international events;
- the impact of the spread of epidemics and viral outbreaks;

## [Table of Contents](#)

- the impact of any future changes relating to how external distribution channels sell and market our cruises;
- our reliance on third parties to provide hotel management services to certain of our ships and certain other services;
- the impact of delays in our shipbuilding program and ship repairs, maintenance and refurbishments;
- the impact of any future increases in the price of, or major changes or reduction in, commercial airline services;
- the impact of seasonal variations in passenger fare rates and occupancy levels at different times of the year;
- the effect of adverse incidents involving cruise ships and our ability to obtain adequate insurance coverage;
- the impact of any breaches in data security or other disturbances to our information technology and other networks;
- our ability to keep pace with developments in technology;
- the impact of amendments to our collective bargaining agreements for crew members and other employee relation issues;
- the continued availability of attractive port destinations;
- the impact of pending or threatened litigation, investigations and enforcement actions;
- changes involving the tax and environmental regulatory regimes in which we operate;
- the significant percentage of ordinary shares held by our Sponsors; and
- other factors set forth under “Risk Factors” in our most recently filed Annual Report on Form 10-K and “Item 1A Risk Factors” in this report.

The above examples are not exhaustive and new risks emerge from time to time. Our forward-looking statements are based on our current beliefs, assumptions, expectations, estimates and projections regarding our present and future business strategies and the environment in which we will operate in the future. These forward-looking statements speak only as of the date made. We expressly disclaim any obligation or undertaking to release publicly any updates or revisions to any forward-looking statement contained herein to reflect any change in our expectations with regard thereto or any change of events, conditions or circumstances on which any such statement was based, except as required by law.

The interim consolidated financial statements should be read in conjunction with our audited consolidated financial statements for the year ended December 31, 2014, which are included in our most recently filed Annual Report on Form 10-K.

### **Terminology**

This report includes certain non-GAAP financial measures, such as Net Revenue, Net Yield, Net Cruise Cost, Adjusted Net Yield, Adjusted Net Revenue, Adjusted Net Cruise Cost Excluding Fuel, Adjusted EBITDA, Adjusted Net Income and Adjusted EPS. Definitions of these non-GAAP financial measures are included below. For further information about our non-GAAP financial measures including detailed adjustments made in calculating our non-GAAP financial measures and a reconciliation to the most directly comparable GAAP financial measure, we refer you to “Results of Operations” below. Unless otherwise indicated in this report, the following terms have the meanings set forth below:

- *Acquisition of Prestige*. In November 2014, pursuant to the Merger Agreement, we acquired Prestige in a cash and stock transaction for total consideration of \$3.025 billion, including the assumption of debt. The acquisition consideration is subject to an additional cash payment of up to \$50 million upon achievement of certain 2015 revenue milestones.
- *Adjusted EBITDA*. EBITDA adjusted for other income (expense) and other supplemental adjustments.
- *Adjusted EPS*. Adjusted Net Income divided by the number of diluted weighted-average shares.
- *Adjusted Net Cruise Cost Excluding Fuel*. Net Cruise Cost less fuel expense adjusted for supplemental adjustments.
- *Adjusted Net Income*. Net income adjusted for supplemental adjustments.

## [Table of Contents](#)

- *Adjusted Net Revenue*. Net Revenue adjusted for supplemental adjustments.
- *Adjusted Net Yield*. Net Yield adjusted for supplemental adjustments.
- *Berths*. Double occupancy capacity per stateroom (single occupancy per studio stateroom) even though many staterooms can accommodate three or more passengers.
- *Breakaway Class Ships*. Norwegian Breakaway and Norwegian Getaway.
- *Breakaway Plus Class Ships*. The next generation of ships which are similar in design and innovation to Breakaway Class Ships.
- *Breakaway Two Credit Facility*. €529.8 million Breakaway Two Credit Agreement, dated as of November 18, 2010, by and among Breakaway Two, Ltd. and a syndicate of international banks and related Guarantee by NCL Corporation Ltd., as amended.
- *Business Enhancement Capital Expenditures*. Capital expenditures other than those related to new ship construction and ROI Capital Expenditures.
- *Capacity Days*. Available Berths multiplied by the number of cruise days for the period.
- *Charter*. The hire of a ship for a specified period of time.
- *Constant Currency*. A calculation whereby foreign currency-denominated revenue and expenses in a period are converted at the U.S. dollar exchange rate of a comparable period in order to eliminate the effects of the foreign exchange fluctuations.
- *Dry-dock*. A process whereby a ship is positioned in a large basin where all of the fresh/sea water is pumped out in order to carry out cleaning and repairs of those parts of a ship which are below the water line.
- *Gross Tons*. A unit of enclosed passenger space on a cruise ship, such that one gross ton = 100 cubic feet or 2.831 cubic meters.
- *EBITDA*. Earnings before interest, taxes, depreciation and amortization.
- *EPS*. Earnings per share.
- *GAAP*. Generally accepted accounting principles in the U.S.
- *Gross Cruise Cost*. The sum of total cruise operating expense and marketing, general and administrative expense.
- *Gross Yield*. Total revenue per Capacity Day.
- *IPO*. The initial public offering of 27,058,824 ordinary shares, par value \$.001 per share, of NCLH, which was consummated on January 24, 2013.
- *Management NCL Corporation Units*. NCLC's previously outstanding profits interests issued to management (or former management) of NCLC which were converted into units in NCLC in connection with the Corporate Reorganization.
- *Merger Agreement*. Agreement and Plan of Merger, dated as of September 2, 2014, by and among Prestige, NCLH, Portland Merger Sub, Inc. and Apollo Management, L.P., as amended, for the Acquisition of Prestige.
- *Net Cruise Cost*. Gross Cruise Cost less commissions, transportation and other expense and onboard and other expense.
- *Net Cruise Cost Excluding Fuel*. Net Cruise Cost less fuel expense.
- *Net Revenue*. Total revenue less commissions, transportation and other expense and onboard and other expense.
- *Net Yield*. Net Revenue per Capacity Day.

[Table of Contents](#)

- *Occupancy Percentage.* The ratio of Passenger Cruise Days to Capacity Days. A percentage in excess of 100% indicates that three or more passengers occupied some staterooms.
- *Passenger Cruise Days.* The number of passengers carried for the period, multiplied by the number of days in their respective cruises.
- *Revolving Loan Facility.* \$625.0 million senior secured revolving credit facility maturing on May 24, 2018.
- *Secondary Equity Offering(s).* Secondary public offering(s) of NCLH's ordinary shares in May 2015, March 2015, March 2014, December 2013 and August 2013.
- *Selling Shareholders.* Apollo Holders, Star NCLC and the TPG Viking Funds.
- *Shipboard Retirement Plan.* An unfunded defined benefit pension plan for certain crew members which computes benefits based on years of service, subject to certain requirements.

## **Non-GAAP Financial Measures**

We use certain non-GAAP financial measures, such as Net Revenue, Adjusted Net Revenue, Gross Yield, Net Yield, Adjusted Net Yield, Net Cruise Cost, Adjusted Net Cruise Cost Excluding Fuel, Adjusted EBITDA, Adjusted Net Income and Adjusted EPS, to enable us to analyze our performance. See “Terminology” for the definitions of these non-GAAP financial measures. We utilize Net Revenue and Net Yield to manage our business on a day-to-day basis and believe that they are the most relevant measures of our revenue performance because they reflect the revenue earned by us net of significant variable costs. In measuring our ability to control costs in a manner that positively impacts net income, we believe changes in Net Cruise Cost and Adjusted Net Cruise Cost Excluding Fuel to be the most relevant indicators of our performance.

As our business includes the sourcing of passengers and deployment of vessels outside of North America, a portion of our revenue and expenses are denominated in foreign currencies, particularly euro and British Pound sterling, which are subject to fluctuations in currency exchange rates versus our reporting currency, the U.S. dollar. In order to monitor results excluding these fluctuations, we calculate certain non-GAAP measures on a Constant Currency basis whereby current period revenue and expenses denominated in foreign currencies are converted to U.S. dollars using currency exchange rates of the comparable period. We believe that presenting these non-GAAP measures on both a reported and Constant Currency basis is useful in providing a more comprehensive view of trends in our business.

We believe that Adjusted EBITDA is appropriate as a supplemental financial measure as it is used by management to assess operating performance. We believe that Adjusted EBITDA is a useful measure in determining our performance as it reflects certain operating drivers of our business, such as sales growth, operating costs, marketing, general and administrative expense and other operating income and expense. Adjusted EBITDA is not a defined term under GAAP. Adjusted EBITDA is not intended to be a measure of liquidity or cash flows from operations or a measure comparable to net income as it does not take into account certain requirements such as capital expenditures and related depreciation, principal and interest payments and tax payments and it includes other supplemental adjustments.

In addition, Adjusted Net Revenue and Adjusted Net Yield, which excludes certain business combination accounting entries, are non-GAAP financial measures that we believe are useful as supplemental measures in evaluating the performance of our operating business and provide greater transparency into our results of operations. Adjusted Net Income and Adjusted EPS are non-GAAP financial measures that exclude certain charges and are used to supplement GAAP net income and EPS. We use Adjusted Net Income and Adjusted EPS as key performance measures of our earnings performance. We believe that both management and investors benefit from referring to these non-GAAP financial measures in assessing our performance and when planning, forecasting and analyzing future periods. These non-GAAP financial measures also facilitate management’s internal comparison to our historical performance. The charges excluded in the presentation of these non-GAAP financial measures may vary from period to period; accordingly, our presentation of Adjusted Net Revenue, Adjusted Net Yield, Adjusted Net Income and Adjusted EPS may not be indicative of future adjustments or results.

You are encouraged to evaluate each adjustment used in calculating our non-GAAP financial measures and the reasons we consider our non-GAAP financial measures appropriate for supplemental analysis. In evaluating our non-GAAP financial measures, you should be aware that in the future we may incur expenses similar to the adjustments in our presentation. Our non-GAAP financial measures have limitations as analytical tools, and you should not consider these measures in isolation or as a substitute for analysis of our results as reported under GAAP. Our presentation of our non-GAAP financial measures should not be construed as an inference that our future results will be unaffected by unusual or non-recurring items. Our non-GAAP financial measures may not be comparable to other companies. Please see a historical reconciliation of these measures to the most comparable GAAP measure presented in our consolidated financial statements below in the “Results of Operations” section.

## **Financial Presentation**

Revenue from our cruise and cruise-related activities are categorized by us as “passenger ticket revenue” and “onboard and other revenue.” Passenger ticket revenue and onboard and other revenue vary according to product offering, the size of the ship in operation, the length of cruises operated and the markets in which the ship operates. Our revenue is seasonal based on demand for cruises, which has historically been strongest during the summer months.

Passenger ticket revenue primarily consists of revenue for accommodations, meals in certain restaurants on the ship, certain onboard entertainment, and includes revenue for service charges and air and land transportation to and from the ship to the extent guests purchase these items from us. Onboard and other revenue primarily consists of revenue from gaming, beverage sales, shore excursions, specialty dining, retail sales, spa services, photo services as well as certain Charter revenue. We record onboard revenue from onboard activities we perform directly or that are performed by independent concessionaires, from which we receive a share of their revenue.

## [Table of Contents](#)

Our cruise operating expense is classified as follows:

- Commissions, transportation and other primarily consists of direct costs associated with passenger ticket revenue. These costs include travel agent commissions, air and land transportation expenses, related credit card fees, costs associated with service charges, certain port expenses, the costs associated with shore excursions and hotel accommodations included as part of the overall cruise purchase price.
- Onboard and other primarily consists of direct costs that are incurred in connection with onboard and other revenue. These include costs incurred in connection with shore excursions, beverage sales and gaming.
- Payroll and related consists of the cost of wages and benefits for shipboard employees and costs for a third party that provides crew and other services for certain of our ships.
- Fuel includes fuel costs, the impact of certain fuel hedges and fuel delivery costs.
- Food consists of food costs for passengers and crew on certain of our ships.
- Other consists of repairs and maintenance (including Dry-dock costs), ship insurance, Charter costs and other ship expenses.

### Critical Accounting Policies

For a discussion of our critical accounting policies and estimates, see “Critical Accounting Policies” included in our Annual Report on Form 10-K for the year ended December 31, 2014 under the caption “Management’s Discussion and Analysis of Financial Condition and Results of Operations.” We have made no significant changes to our critical accounting policies and estimates from those described in our Annual Report on Form 10-K for the year ended December 31, 2014.

### Quarterly Overview

For the second quarter of 2015, on a GAAP basis, net income and diluted earnings per share were \$158.5 million and \$0.69, respectively. We reported Adjusted Net Income of \$171.6 million and Adjusted EPS of \$0.75, which primarily excludes \$3.3 million of expenses related to non-cash compensation, \$1.0 million related to Secondary Equity Offering expenses, \$3.3 million of expenses related to severance costs, \$10.9 million related to the Acquisition of Prestige, \$7.3 million of a deferred revenue adjustment, \$20.9 million related to the amortization of intangible assets, \$(34.3) million of contingent consideration income adjustment and \$0.7 million related to derivative adjustments.

In May 2015, the Selling Shareholders sold 20,000,000 ordinary shares of NCLH in a Secondary Equity Offering. We did not receive any proceeds from this offering.

### Three months ended June 30, 2015 (“2015”) compared to the three months ended June 30, 2014 (“2014”)

Total revenue increased 41.7% to \$1,085.4 million in 2015 compared to \$765.9 million in 2014. Net Revenue in 2015 increased 38.5% to \$825.1 million from \$595.7 million in 2014 due to an increase in Capacity Days of 18.2% and Net Yield of 17.2%. The increase in Capacity Days was primarily due to the Acquisition of Prestige.

Operating income was \$217.4 million in 2015 compared to \$148.6 million in 2014 and Adjusted EBITDA (we refer you to our “Results of Operations” below for a calculation of Adjusted EBITDA) improved 42.8% for the same period.

### Results of Operations

The following table sets forth operating data as a percentage of total revenue:

	Three Months Ended June 30,		Six Months Ended June 30,	
	2015	2014	2015	2014
<b>Revenue</b>				
Passenger ticket	72.6%	69.0%	72.1%	68.3%
Onboard and other	27.4%	31.0%	27.9%	31.7%
Total revenue	100.0%	100.0%	100.0%	100.0%
<b>Cruise operating expense</b>				
Commissions, transportation and other	17.7%	15.0%	18.0%	16.2%
Onboard and other	6.3%	7.2%	6.3%	7.2%
Payroll and related	14.9%	13.9%	15.8%	14.4%
Fuel	8.5%	10.2%	8.9%	11.0%
Food	4.0%	5.6%	4.2%	5.6%
Other	9.1%	9.6%	10.1%	9.7%
Total cruise operating expense	60.5%	61.5%	63.3%	64.1%
<b>Other operating expense</b>				
Marketing, general and administrative	9.9%	10.8%	12.9%	11.6%
Depreciation and amortization	9.6%	8.3%	10.1%	8.8%
Total other operating expense	19.5%	19.1%	23.0%	20.4%
Operating income	20.0%	19.4%	13.7%	15.5%
<b>Non-operating income (expense)</b>				
Interest expense, net	(4.8)%	(4.2)%	(5.1)%	(4.4)%
Other income (expense)	(0.4)%	—%	(1.7)%	—%



Total non-operating income (expense)	(5.2)%	(4.2)%	(6.8)%	(4.4)%
<b>Net income before income taxes</b>	14.8%	15.2%	6.9%	11.1%
<b>Income tax benefit (expense)</b>	(0.2)%	(0.4)%	(0.1)%	0.4%
<b>Net income</b>	14.6%	14.8%	6.8%	11.5%
<b>Net income attributable to non-controlling interest</b>	—%	0.2%	—%	0.1%
<b>Net income attributable to Norwegian Cruise Line Holdings Ltd.</b>	14.6%	14.6%	6.8%	11.4%

[Table of Contents](#)

The following table sets forth selected statistical information:

	Three Months Ended June 30,		Six Months Ended June 30,	
	2015	2014	2015	2014
Passengers carried	527,676	482,837	1,041,202	990,109
Passenger Cruise Days	3,948,773	3,394,649	7,716,888	6,470,051
Capacity Days	3,634,143	3,074,415	7,190,611	5,970,399
Occupancy Percentage	108.7%	110.4%	107.3%	108.4%

Net Revenue, Adjusted Net Revenue, Gross Yield, Net Yield and Adjusted Net Yield were calculated as follows (in thousands, except Capacity Days and Yield data):

	Three Months Ended June 30,			Six Months Ended June 30,		
	2015		2014	2015		2014
	2015	Constant Currency		2015	Constant Currency	
Passenger ticket revenue	\$ 787,991	\$ 806,372	\$ 528,782	\$ 1,458,474	\$ 1,485,065	\$ 977,362
Onboard and other revenue	297,442	296,994	237,145	565,141	564,693	452,593
Total revenue	1,085,433	1,103,366	765,927	2,023,615	2,049,758	1,429,955
Less:						
Commissions, transportation and other expense	192,438	196,721	114,712	364,265	370,510	231,522
Onboard and other expense	67,885	67,435	55,467	126,530	126,080	103,391
Net Revenue	825,110	839,210	595,748	1,532,820	1,553,168	1,095,042
<b>Non-GAAP Adjustment:</b>						
Deferred revenue (1)	7,294	7,294	—	28,488	28,488	—
Adjusted Net Revenue	\$ 832,404	\$ 846,504	\$ 595,748	\$ 1,561,308	\$ 1,581,656	\$ 1,095,042
Capacity Days	3,634,143	3,634,143	3,074,415	7,190,611	7,190,611	5,970,399
Gross Yield	\$ 298.68	\$ 303.61	\$ 249.13	\$ 281.42	\$ 285.06	\$ 239.51
Net Yield	\$ 227.04	\$ 230.92	\$ 193.78	\$ 213.17	\$ 216.00	\$ 183.41
Adjusted Net Yield	\$ 229.05	\$ 232.93	\$ 193.78	\$ 217.13	\$ 219.96	\$ 183.41

- (1) Reflects deferred revenue fair value adjustments totaling \$7.3 million and \$28.5 million for the three months and six months ended June 30, 2015, respectively, related to the Acquisition of Prestige that were made pursuant to business combination accounting rules.

[Table of Contents](#)

Gross Cruise Cost, Net Cruise Cost, Net Cruise Cost Excluding Fuel and Adjusted Net Cruise Cost Excluding Fuel were calculated as follows (in thousands, except Capacity Days and per Capacity Day data):

	Three Months Ended June 30,			Six Months Ended June 30,		
	2015	2015 Constant Currency	2014	2015	2015 Constant Currency	2014
Total cruise operating expense	\$ 656,279	\$ 661,730	\$ 470,796	\$ 1,279,979	\$ 1,288,029	\$ 916,706
Marketing, general and administrative expense	107,164	108,738	83,084	261,321	264,051	166,473
Gross Cruise Cost	763,443	770,468	553,880	1,541,300	1,552,080	1,083,179
Less:						
Commissions, transportation and other expense	192,438	196,722	114,712	364,265	370,510	231,522
Onboard and other expense	67,885	67,435	55,467	126,530	126,080	103,391
Net Cruise Cost	503,120	506,311	383,701	1,050,505	1,055,490	748,266
Less: Fuel expense	91,581	91,581	77,832	178,955	178,955	156,872
Net Cruise Cost Excluding Fuel	411,539	414,730	305,869	871,550	876,535	591,394
<b>Less Non-GAAP Adjustments:</b>						
Non-cash deferred compensation (1)	1,029	1,029	1,770	2,482	2,482	2,609
Non-cash share-based compensation (2)	2,161	2,161	3,244	14,166	14,166	5,079
Secondary Equity Offering expenses (3)	1,022	1,022	—	1,022	1,022	1,877
Severance payments and other fees (4)	3,289	3,289	—	13,676	13,676	—
Management NCL Corporation Units exchange expenses (5)	—	—	—	624	624	—
Acquisition of Prestige expenses (6)	10,891	10,891	—	11,291	11,291	—
Contingent consideration adjustment (7)	(34,300)	(34,300)	—	(43,400)	(43,400)	—
Other (8)	—	—	2,331	—	—	2,331
Adjusted Net Cruise Cost Excluding Fuel	\$ 427,447	\$ 430,638	\$ 298,524	\$ 871,689	\$ 876,674	\$ 579,498
Capacity Days	3,634,143	3,634,143	3,074,415	7,190,611	7,190,611	5,970,399
Gross Cruise Cost per Capacity Day	\$ 210.08	\$ 212.01	\$ 180.16	\$ 214.35	\$ 215.85	\$ 181.42
Net Cruise Cost per Capacity Day	\$ 138.44	\$ 139.32	\$ 124.80	\$ 146.09	\$ 146.79	\$ 125.33
Net Cruise Cost Excluding Fuel per Capacity Day	\$ 113.24	\$ 114.12	\$ 99.49	\$ 121.21	\$ 121.90	\$ 99.05
Adjusted Net Cruise Cost Excluding Fuel per Capacity Day	\$ 117.62	\$ 118.50	\$ 97.10	\$ 121.23	\$ 121.92	\$ 97.06

- (1) Non-cash share-based compensation expenses related to the crew pension plan, which are included in payroll and related expense.
- (2) Non-cash share-based compensation expenses related to equity grants, which are included in marketing, general and administrative expense.
- (3) Expenses related to the Secondary Equity Offerings, which are included in marketing, general and administrative expense.
- (4) Severance payments and other expenses related to restructuring costs and other severance arrangements, which are included in marketing, general and administrative expense.
- (5) Expenses related to the exchange of Management NCL Corporation Units for ordinary shares, which are included in marketing, general and administrative expense.
- (6) Expenses related to the Acquisition of Prestige, which are included in marketing, general and administrative expense.
- (7) Contingent consideration fair value adjustment related to the Acquisition of Prestige, which is included in marketing, general and administrative expense.
- (8) Expenses primarily related to the Corporate Reorganization and the settlement of a 2007 breach of contract claim, which are included in marketing, general and administrative expense.

[Table of Contents](#)

Adjusted Net Income and Adjusted EPS were calculated as follows (in thousands, except share and per share data):

	Three Months Ended June 30,		Six Months Ended June 30,	
	2015	2014	2015	2014
Net income attributable to Norwegian Cruise Line Holdings Ltd.	\$ 158,494	\$ 111,616	\$ 137,038	\$ 162,883
Net income attributable to non-controlling interest	—	1,663	—	2,088
Net income	158,494	113,279	137,038	164,971
<b>Non-GAAP Adjustments:</b>				
Non-cash deferred compensation (1)	1,029	1,770	2,482	2,609
Non-cash share-based compensation (2)	2,334	3,244	14,339	5,079
Secondary Equity Offerings' expenses (3)	1,022	—	1,022	1,877
Tax benefit (4)	—	511	—	(6,174)
Severance payments and other fees (5)	3,289	—	13,676	—
Management NCL Corporation Units exchange expenses (6)	—	—	624	—
Acquisition of Prestige expenses (7)	10,891	—	11,291	—
Deferred revenue (8)	7,294	—	28,488	—
Amortization of intangible assets (9)	20,913	—	39,059	—
Contingent consideration adjustment (10)	(34,300)	—	(43,400)	—
Derivative expense (11)	650	—	29,603	—
Other (12)	—	2,331	—	2,331
Adjusted Net Income	\$ 171,616	\$ 121,135	\$ 234,222	\$ 170,693
Diluted weighted-average shares outstanding – Net income	230,228,144	210,472,991	229,664,210	210,742,655
Diluted weighted-average shares outstanding – Adjusted Net Income	230,228,144	210,472,991	229,664,210	210,742,655
Diluted earnings per share	\$ 0.69	\$ 0.54	\$ 0.60	\$ 0.78
Adjusted EPS	\$ 0.75	\$ 0.58	\$ 1.02	\$ 0.81

- (1) Non-cash share-based compensation expenses related to the crew pension plan, which are included in payroll and related expense.
- (2) Non-cash share-based compensation expenses related to equity grants, which are included in marketing, general and administrative expense.
- (3) Expenses related to the Secondary Equity Offerings, which are included in marketing, general and administrative expense.
- (4) Tax benefit of \$6.2 million from a change in estimate of tax provision associated with a change in our corporate entity structure, which is included in income tax benefit (expense).
- (5) Severance payments and other expenses related to restructuring costs and other severance arrangements, which are included in marketing, general and administrative expense.
- (6) Expenses related to the exchange of Management NCL Corporation Units for ordinary shares, which are included in marketing, general and administrative expense.
- (7) Expenses related to the Acquisition of Prestige, which are included in marketing, general and administrative expense.
- (8) Deferred revenue fair value adjustments related to the Acquisition of Prestige that were made pursuant to business combination accounting rules, which are primarily included in Net Revenue.
- (9) Amortization of intangible assets related to the Acquisition of Prestige, which are included in depreciation and amortization expense.
- (10) Contingent consideration fair value adjustment related to the Acquisition of Prestige, which is included in marketing, general and administrative expense.
- (11) Losses of approximately \$(10.0) million related to certain fuel swap derivative hedge contracts and the fair value adjustment of \$9.4 million for a foreign exchange collar which does not receive hedge accounting treatment, which are included in other income (expense) for the three months ended June 30, 2015. Losses of \$(19.6) million for a foreign exchange collar which does not receive hedge accounting treatment and \$(10.0) million related to certain fuel swap derivative hedge contracts for the six months ended June 30, 2015.
- (12) Expenses primarily related to the Corporate Reorganization and the settlement of a 2007 breach of contract claim, which are included in marketing, general and administrative expense.

[Table of Contents](#)

EBITDA and Adjusted EBITDA was calculated as follows (in thousands):

	Three Months Ended June 30,		Six Months Ended June 30,	
	2015	2014	2015	2014
Net income attributable to Norwegian Cruise Line Holdings Ltd.	\$ 158,494	\$ 111,616	\$ 137,038	\$ 162,883
Interest expense, net	52,446	31,860	103,435	63,032
Income tax (benefit) expense	2,726	3,124	3,403	(6,263)
Depreciation and amortization expense	104,607	63,459	204,583	125,099
EBITDA	318,273	210,059	448,459	344,751
Net income attributable to Non-controlling interest	—	1,663	—	2,088
Other (income) expense	3,717	325	33,856	(63)
<b>Non-GAAP Adjustments:</b>				
Non-cash deferred compensation (1)	1,029	1,770	2,482	2,609
Non-cash share-based compensation (2)	2,161	3,244	14,166	5,079
Secondary Equity Offerings' expenses (3)	1,022	—	1,022	1,877
Severance payments and other fees (4)	3,289	—	13,676	—
Management NCL Corporation Units exchange expenses (5)	—	—	624	—
Acquisition of Prestige expenses (6)	10,891	—	11,291	—
Deferred revenue (7)	7,294	—	28,488	—
Contingent consideration adjustment (8)	(34,300)	—	(43,400)	—
Other (9)	—	2,331	—	2,331
Adjusted EBITDA	\$ 313,376	\$ 219,392	\$ 510,664	\$ 358,672

- (1) Non-cash share-based compensation expenses related to the crew pension plan, which are included in payroll and related expense.
- (2) Non-cash share-based compensation expenses related to equity grants, which are included in marketing, general and administrative expense.
- (3) Expenses related to the Secondary Equity Offerings, which are included in marketing, general and administrative expense.
- (4) Severance payments and other expenses related to restructuring costs and other severance arrangements, which are included in marketing, general and administrative expense.
- (5) Expenses related to the exchange of Management NCL Corporation Units for ordinary shares, which are included in marketing, general and administrative expense.
- (6) Expenses related to the Acquisition of Prestige, which are included in marketing, general and administrative expense.
- (7) Deferred revenue fair value adjustments related to the Acquisition of Prestige that were made pursuant to business combination accounting rules, which are primarily included in Net Revenue.
- (8) Contingent consideration fair value adjustment related to the Acquisition of Prestige, which is included in marketing, general and administrative expense.
- (9) Expenses primarily related to the Corporate Reorganization and the settlement of a 2007 breach of contract claim, which are included in marketing, general and administrative expense.

**Three months ended June 30, 2015 ("2015") compared to three months ended June 30, 2014 ("2014")**

**Revenue**

Total revenue increased 41.7% to \$1,085.4 million in 2015 compared to \$765.9 million in 2014. Net Revenue in 2015 increased 38.5% to \$825.1 million from \$595.7 million in 2014 due to an increase in Capacity Days of 18.2% and Net Yield of 17.2%. The increase in Capacity Days was primarily due to the Acquisition of Prestige. The increase in Net Yield was primarily due to an increase in passenger ticket pricing and higher onboard and other revenue. Adjusted Net Revenue includes a deferred revenue fair value adjustment of \$7.3 million related to the Acquisition of Prestige. On a Constant Currency basis, Net Yield and Adjusted Net Yield increased 19.2% and 20.2%, respectively, in 2015 compared to 2014.

**Expense**

Total cruise operating expense increased 39.4% in 2015 compared to 2014 primarily due to the increase in Capacity Days as discussed above. Total other operating expense increased 44.5% in 2015 compared to 2014 primarily due to the amortization expense related to the intangible assets and depreciation related to the Prestige ships and an increase in marketing general and administrative expenses primarily related to the Acquisition of Prestige partially offset by the adjustment for the contingent consideration related to the Acquisition of Prestige. On a Capacity Day basis, Net Cruise Cost increased 10.9% (11.6% on a Constant Currency basis) due to certain crew related expenses and an increase in marketing general and administrative expenses as discussed above. Adjusted Net Cruise Cost Excluding Fuel per Capacity Day increased 21.1% (22.0% on a Constant Currency basis) primarily due to the increase in expenses discussed above.

## [Table of Contents](#)

Interest expense, net increased to \$52.4 million in 2015 from \$31.9 million in 2014 primarily due to an increase in average debt outstanding in connection with the Acquisition of Prestige. Other income (expense) was an expense of \$3.7 million in 2015 compared to \$0.3 million in 2014 primarily related to the expense recorded from the dedesignation of certain fuel swap derivative hedge contracts and the ineffectiveness of settled fuel swaps in 2015. The expense was partially offset by income related to the fair value adjustment for a foreign exchange collar which does not receive hedge accounting treatment.

In 2015, we had an income tax expense of \$2.7 million compared to \$3.1 million in 2014.

### **Six months ended June 30, 2015 (“2015”) compared to six months ended June 30, 2014 (“2014”)**

#### ***Revenue***

Total revenue increased 41.5% to \$2,023.6 million in 2015 compared to \$1,430.0 million in 2014. Net Revenue in 2015 increased 40.0% to \$1,532.8 million from \$1,095.0 million in 2014 due to an increase in Capacity Days of 20.4% and Net Yield of 16.2%. The increase in Capacity Days was primarily due to the Acquisition of Prestige and the operation of Norwegian Getaway for the entire six months of 2015. The increase in Net Yield was primarily due to an increase in passenger ticket pricing and higher onboard and other revenue. Adjusted Net Revenue includes a deferred revenue fair value adjustment of \$28.5 million related to the Acquisition of Prestige. On a Constant Currency basis, Net Yield and Adjusted Net Yield increased 17.8% and 19.9%, respectively, in 2015 compared to 2014.

#### ***Expense***

Total cruise operating expense increased 39.6% in 2015 compared to 2014 primarily due to the increase in Capacity Days as discussed above. Total other operating expense increased 59.8% in 2015 compared to 2014 primarily due to an increase in marketing general and administrative expenses primarily related to the Acquisition of Prestige including certain restructuring and severance costs, as well as amortization expense related to the intangible assets and depreciation related to the Prestige ships. This was partially offset by the adjustment for the contingent consideration related to the Acquisition of Prestige. On a Capacity Day basis, Net Cruise Cost increased 16.6% (17.1% on a Constant Currency basis) due to an increase in marketing general and administrative expenses as discussed above and certain crew related expenses partially offset by the decrease in fuel expense which was primarily the result of a 14.4% decrease in the average fuel price to \$542 per metric ton in 2015 from \$633 per metric ton in 2014. Adjusted Net Cruise Cost Excluding Fuel per Capacity Day increased 24.9% (25.6% on a Constant Currency basis) primarily due to the increase in expenses discussed above.

Interest expense, net increased to \$103.4 million in 2015 from \$63.0 million in 2014 primarily due to an increase in average debt outstanding in connection with the Acquisition of Prestige. Other income (expense) was an expense of \$33.9 million in 2015 compared to income of \$63.0 thousand in 2014 primarily related to the expense from the dedesignation of certain fuel swap derivative hedge contracts and the ineffectiveness of settled fuel swaps in 2015. Also included in 2015 was the expense related to the fair value adjustment for a foreign exchange collar which does not receive hedge accounting treatment.

In 2015, we had an income tax expense of \$3.4 million. In 2014, we had an income tax benefit of \$6.3 million. During the fourth quarter of 2013, we completed the implementation of a global tax platform, which had a favorable impact on the amount of income subject to U.S. corporate tax. This favorable impact continued through calendar year 2014. In addition, during the first quarter of 2014, we received information which allowed us to elect a tax method to calculate deductible interest expense resulting in a tax benefit of \$11.1 million including a \$6.2 million non-recurring benefit that has been excluded from Adjusted Net Income and Adjusted EPS for the six months ended June 30, 2014.

### **Liquidity and Capital Resources**

#### ***General***

As of June 30, 2015, our liquidity was \$798.0 million consisting of \$173.0 million in cash and cash equivalents and \$625.0 million, which is the full amount available under our Revolving Loan Facility. Our primary ongoing liquidity requirements are to finance working capital, capital expenditures and debt service.

As of June 30, 2015, we had a working capital deficit of \$2.1 billion. This deficit included \$1.2 billion of advance ticket sales, which represents the passenger ticket revenue we collect in advance of sailing dates, and accordingly, are substantially more like deferred revenue balances rather than actual current cash liabilities. Our business model, along with our Revolving Loan Facility, allows us to operate with a working capital deficit and still meet our operating, investing and financing needs.

**Sources and Uses of Cash**

*In this section, references to “2015” refer to the six months ended June 30, 2015 and references to “2014” refer to the six months ended June 30, 2014.*

Net cash provided by operating activities was \$692.1 million in 2015 as compared to \$519.1 million in 2014. The change in net cash provided by operating activities included timing differences in cash receipts and payments relating to operating assets and liabilities with advance ticket sales of \$412.6 million in 2015 compared to \$194.9 million in 2014. The increase was partially offset by lower net income of \$137.0 million in 2015 compared to net income of \$165.0 million in 2014.

Net cash used in investing activities was \$186.5 million in 2015, primarily related to payments for our newbuild ships and ship improvements and shoreside projects. Net cash used in investing activities was \$787.6 million in 2014, primarily related to the payments for delivery of Norwegian Getaway and other ship improvements and shoreside projects.

Net cash used in financing activities was \$417.5 million in 2015, primarily due to repayments of our Revolving Loan Facility and other loan facilities. Net cash provided by financing activities was \$275.5 million in 2014, primarily due to proceeds from the Breakaway Two Credit Facility.

**Future Capital Commitments**

Future capital commitments consist of contracted commitments, including ship construction contracts, and future expected capital expenditures necessary for operations. As of June 30, 2015, anticipated capital expenditures were \$1.0 billion for the remainder of 2015, and \$0.9 billion and \$1.1 billion for each of the years ending December 31, 2016 and 2017, respectively, of which we have export credit financing in place for the expenditures related to ship construction contracts of \$0.7 billion for the remainder of 2015, \$0.5 billion for 2016 and \$0.6 billion for 2017.

We have four Breakaway Plus Class Ships on order with Meyer Werft shipyard for delivery in the fall of 2015, spring of 2017, spring of 2018 and fall of 2019. These ships will be the largest in our fleet, reaching approximately 164,600 Gross Tons and up to 4,200 Berths each and will be similar in design and innovation to our Breakaway Class Ships. The combined contract price of these four ships is approximately €3.1 billion, or \$3.5 billion based on the euro/U.S. dollar exchange rate as of June 30, 2015. We have export credit financing in place that provides financing for 80% of their contract prices. We also have a contract with Fincantieri shipyard to build a luxury cruise ship to be named Seven Seas Explorer. The contract price of the ship is approximately €343.0 million, or approximately \$382.3 million based on the euro/U.S. dollar exchange rate as of June 30, 2015. We have export credit financing in place that provides financing for 80% of the ship’s contract price. Seven Seas Explorer is expected to be delivered in the summer of 2016.

In connection with the contracts to build these ships, we do not anticipate any contractual breaches or cancellation to occur. However, if any would occur, it could result in, among other things, the forfeiture of prior deposits or payments made by us, subject to certain refund guarantees, and potential claims and impairment losses which may materially impact our business, financial condition and results of operations.

Capitalized interest for the three and six months ended June 30, 2015 was \$7.4 million and \$15.1 million, respectively, and for the three and six months ended June 30, 2014 was \$4.1 million and \$9.2 million, respectively, primarily associated with the construction of our Breakaway Plus Class Ships.

**Off-Balance Sheet Transactions**

None.

**Contractual Obligations**

As of June 30, 2015, our contractual obligations, with initial or remaining terms in excess of one year, including interest payments on long-term debt obligations, were as follows (in thousands):

	Total	Less than 1 year	1-3 years	3-5 years	More than 5 years
Long-term debt (1)	\$ 5,763,919	\$ 585,875	\$ 2,213,864	\$ 1,310,419	\$ 1,653,761
Due to Affiliate (2)	38,737	38,737	—	—	—
Operating leases (3)	150,014	11,579	24,542	24,750	89,143
Ship construction contracts (4)	3,713,432	1,314,918	1,629,128	769,386	—
Port facilities (5)	198,815	31,675	53,809	41,719	71,612
Interest (6)	777,830	173,353	305,256	167,641	131,580
Other (7)	121,644	48,453	32,510	13,943	26,738
Total	<u>\$ 10,764,391</u>	<u>\$ 2,204,590</u>	<u>\$ 4,259,109</u>	<u>\$ 2,327,858</u>	<u>\$ 1,972,834</u>

## [Table of Contents](#)

- (1) Net of unamortized original issue discount of \$0.9 million and includes premiums aggregating \$0.8 million. Also includes capital leases.
- (2) Primarily related to the purchase of Norwegian Sky.
- (3) Primarily for offices, motor vehicles and office equipment.
- (4) For our newbuild ships based on the euro/U.S. dollar exchange rate as of June 30, 2015. Export credit financing is in place from a syndicate of banks.
- (5) Primarily for our usage of certain port facilities.
- (6) Includes fixed and variable rates with LIBOR held constant as of June 30, 2015.
- (7) Future commitments for service, maintenance and other Business Enhancement Capital Expenditure contracts.

As of June 30, 2015, we had a liability for unrecognized tax benefits and an accrual for the payment of related interest and penalties totaling \$11.3 million. Due to the uncertainties related to these tax matters, we are unable to make a reasonably reliable estimate when cash settlement with a taxing authority will occur in relation to these liabilities.

### **Other**

Certain of our service providers may require collateral in the normal course of our business. The amount of collateral may change based on certain terms and conditions.

As a routine part of our business, depending on market conditions, exchange rates, pricing and our strategy for growth, we regularly consider opportunities to enter into contracts for the building of additional ships. We may also consider the sale of ships, potential acquisitions and strategic alliances. If any of these were to occur, they may be financed through the incurrence of additional permitted indebtedness, through cash flows from operations, or through the issuance of debt, equity or equity-related securities.

### **Funding Sources**

Our debt agreements contain covenants that, among other things, require us to maintain a minimum level of liquidity, as well as limit our net funded debt-to-capital ratio, maintain certain other ratios and restrict our ability to pay dividends. Our ships and substantially all other property and equipment are pledged as collateral for our debt. We believe we were in compliance with these covenants as of June 30, 2015.

We believe our cash on hand, expected future operating cash inflows, available borrowings under our existing credit facility and our ability to issue debt securities or raise equity, will be sufficient to fund operations, debt payment requirements, capital expenditures and maintain compliance with covenants under our debt agreements over the next twelve-month period. There is no assurance that cash flows from operations and additional financings will be available in the future to fund our future obligations.

## **Item 3. Quantitative and Qualitative Disclosures About Market Risk**

### **General**

We are exposed to market risk attributable to changes in interest rates, foreign currency exchange rates and fuel prices. We attempt to minimize these risks through a combination of our normal operating and financing activities and through the use of derivatives. The financial impacts of these derivative instruments are primarily offset by corresponding changes in the underlying exposures being hedged. We achieve this by closely matching the amount, term and conditions of the derivatives with the underlying risk being hedged. We do not hold or issue derivatives for trading or other speculative purposes. Derivative positions are monitored using techniques including market valuations and sensitivity analyses.

### **Interest Rate Risk**

As of June 30, 2015, we had interest rate swap agreements to mitigate our exposure to interest rate movements and to manage our interest expense. As of June 30, 2015, 55% of our debt was fixed and 45% was variable, which includes the effects of the interest rate swaps. The notional amount of outstanding debt associated with the interest rate swap agreements as of June 30, 2015 was \$1.2 billion. Based on our June 30, 2015 outstanding variable rate debt balance, a one percentage point increase in annual LIBOR interest rates would increase our annual interest expense by approximately \$26.0 million excluding the effects of capitalization of interest.



### ***Foreign Currency Exchange Rate Risk***

As of June 30, 2015, we had foreign currency derivatives to hedge the exposure to volatility in foreign currency exchange rates related to our ship construction contracts denominated in euros. These derivatives hedge the foreign currency exchange rate risk on a portion of the payments on our ship construction contracts and forecasted Dry-dock payments. The payments not hedged aggregate €2.0 billion, or \$2.2 billion based on the euro/U.S. dollar exchange rate as of June 30, 2015. We estimate that a 10% change in the euro as of June 30, 2015 would result in a \$223.4 million change in the U.S. dollar value of the foreign currency denominated remaining payments.

### ***Fuel Price Risk***

Our exposure to market risk for changes in fuel prices relates to the forecasted purchases of fuel on our ships. Fuel expense, as a percentage of our total cruise operating expense, was 14.1% and 16.5% for the three months ended June 30, 2015 and 2014, respectively, and 14.1% and 17.1% for the six months ended June 30, 2015 and 2014, respectively. We use fuel derivative agreements to mitigate the financial impact of fluctuations in fuel prices and as of June 30, 2015, we had hedged approximately 48%, 54%, 44% and 17% of our 2015, 2016, 2017 and 2018 projected metric tons of fuel purchases, respectively. We estimate that a 10% increase in our weighted-average fuel price would increase our anticipated remaining 2015 fuel expense by \$15.9 million. This increase would be partially offset by an increase in the fair value of our fuel swap agreements of \$4.7 million. Fair value of our derivative contracts is derived using valuation models that utilize the income valuation approach. These valuation models take into account the contract terms such as maturity, as well as other inputs such as fuel types, fuel curves, creditworthiness of the counterparty and the Company, as well as other data points.

## **Item 4. Controls and Procedures**

### **Evaluation of Disclosure Controls and Procedures**

Our management has evaluated, with the participation of our Chief Executive Officer and Chief Financial Officer, the effectiveness of our disclosure controls and procedures as of June 30, 2015. There are inherent limitations to the effectiveness of any system of disclosure controls and procedures, including the possibility of human error and the circumvention or overriding of the controls and procedures. Accordingly, even effective disclosure controls and procedures can only provide reasonable assurance of achieving their control objectives. Based upon our management's evaluation, our Chief Executive Officer and Chief Financial Officer concluded that our disclosure controls and procedures were effective as of June 30, 2015 to provide reasonable assurance that the information required to be disclosed by us in the reports we file or submit under the Securities Exchange Act of 1934, as amended, is recorded, processed, summarized and reported within the time periods specified in the rules and forms of the Securities and Exchange Commission, and that it is accumulated and communicated to our management, including our Chief Executive Officer and Chief Financial Officer, as appropriate, to allow timely decisions regarding required disclosure.

### **Changes in Internal Control Over Financial Reporting**

There have been no changes in our internal control over financial reporting during the quarter ended June 30, 2015 that have materially affected, or are reasonably likely to materially affect, our internal control over financial reporting.

### **Limitations on the Effectiveness of Controls**

It should be noted that any system of controls, however well designed and operated, can provide only reasonable, and not absolute, assurance that the objectives of the system will be met. In addition, the design of any control system is based in part upon certain assumptions about the likelihood of future events. Because of these and other inherent limitations of control systems, there is only the reasonable assurance that our controls will succeed in achieving their goals under all potential future conditions.

## PART II. OTHER INFORMATION

### Item 1. Legal Proceedings

In 2015, the Alaska Department of Environmental Conservation issued Notices of Violations to major cruise lines that operated in the state of Alaska, including Norwegian, for alleged violations of the Alaska Marine Vessel Visible Emission Standards that occurred over the last several years. We are cooperating with the state of Alaska and conducting our own internal investigation into these matters. However, we do not believe the ultimate outcome will have a material impact on our financial condition, results of operations or cash flows.

In the normal course of our business, various claims and lawsuits have been filed or are pending against us. Most of these claims and lawsuits are covered by insurance and, accordingly, the maximum amount of our liability is typically limited to our deductible amount. Nonetheless, the ultimate outcome of these claims and lawsuits that are not covered by insurance cannot be determined at this time. We have evaluated our overall exposure with respect to all of our threatened and pending litigation and, to the extent required, we have accrued amounts for all estimable probable losses associated with our deemed exposure. We are currently unable to estimate any other potential contingent losses beyond those accrued, as discovery is not complete nor is adequate information available to estimate such range of loss or potential recovery. We intend to vigorously defend our legal position on all claims and, to the extent necessary, seek recovery.

#### Item 1A. Risk Factors

We refer you to our 2014 Annual Report on Form 10-K for a discussion of the risk factors that affect our business and financial results. We wish to caution the reader that the risk factors discussed in “*Item 1A. Risk Factors*” in our 2014 Annual Report on Form 10-K, and those described below and elsewhere in this report or other Securities and Exchange Commission filings, could cause future results to differ materially from those stated in any forward-looking statements.

*Our hedging strategies may not be cost-effective or adequately protect us from increased costs related to changes in fuel prices.*

In order to manage risks associated with the variable market prices of fuel, we routinely hedge a portion of our future fuel requirements. However, our hedging program may not be successful in mitigating higher fuel costs, and any price protection provided may be limited due to market conditions, including choice of hedging instruments, breakdown of correlation between hedging instrument and market price of fuel and failure of hedge counterparties. To the extent that we use hedge contracts that have the potential to create an obligation to pay upon settlement if fuel prices decline significantly, such hedge contracts may limit our ability to benefit fully from lower fuel costs in the future. There can be no assurance that our hedging arrangements will be cost-effective, will provide any particular level of protection against rises in fuel prices or that our counterparties will be able to perform under our hedging arrangements. Additionally, deterioration in our financial condition could negatively affect our ability to enter into new hedge contracts in the future.

### Item 2. Unregistered Sales of Equity Securities and Use of Proceeds

#### Share Repurchase Program

On April 29, 2014, NCLH’s Board of Directors authorized, and NCLH announced, a three-year share repurchase program for up to \$500.0 million. NCLH may make repurchases in the open market, in privately negotiated transactions, in accelerated repurchase programs or in structured share repurchase programs, and any repurchases may be made pursuant to Rule 10b5-1 plans. There was no share repurchase activity during the three months and six months ended June 30, 2015 and as of June 30, 2015, \$418.0 million remained available for repurchases of our outstanding ordinary shares under the share repurchase program. The increase in treasury shares reported in the consolidated balance sheets as of June 30, 2015 relates to certain forfeitures of restricted ordinary shares held by management or former management of NCLH.

### Item 6. Exhibits

- 2.1 Agreement and Plan of Merger, dated as of September 2, 2014, by and among Prestige Cruises International, Inc., Norwegian Cruise Line Holdings Ltd., Portland Merger Sub, Inc. and Apollo Management, L.P. (incorporated herein by reference to Exhibit 2.1 to Norwegian Cruise Line Holdings Ltd.’s Form 8-K filed on September 4, 2014 (File No. 001-35784))
- 2.2 Amendment No. 1 to the Agreement and Plan of Merger, dated as of October 6, 2014, by and among Prestige Cruises International, Inc., Norwegian Cruise Line Holdings Ltd., Portland Merger Sub, Inc. and Apollo Management, L.P. (incorporated herein by reference to Exhibit 2.1 to Norwegian Cruise Line Holdings Ltd.’s Form 8-K filed on October 8, 2014 (File No. 001-35784))

[Table of Contents](#)

- 3.2 Amended and Restated Bye-Laws of Norwegian Cruise Line Holdings Ltd., effective as of May 20, 2015 (incorporated herein by reference to Exhibit 3.2 to Norwegian Cruise Line Holdings Ltd.'s Form 8-K filed on May 26, 2015 (File No. 001-35784))
- 10.1\* Directors' Compensation Policy
- 10.2\* Amendment No. 9, dated June 30, 2015, to Office Lease Agreement, dated December 1, 2006, as amended, by and between SPUS7 Miami ACC, LP and NCL (Bahamas) Ltd.+
- 31.1\* Certification of the President and Chief Executive Officer pursuant to Rule 13a-14(a) of the Securities Exchange Act of 1934
- 31.2\* Certification of the Executive Vice President and Chief Financial Officer pursuant to Rule 13a-14(a) of the Securities Exchange Act of 1934
- 32.1\*\* Certifications of the President and Chief Executive Officer and the Executive Vice President and Chief Financial Officer pursuant to Rule 13a-14(b) of the Securities Exchange Act of 1934 and Section 1350 of Chapter 63 of Title 18 of the United States Code
- 101\* The following unaudited financial statements are from Norwegian Cruise Line Holdings Ltd.'s Quarterly Report on Form 10-Q for the quarter ended June 30, 2015, formatted in Extensible Business Reporting Language (XBRL), as follows:
  - (i) the Consolidated Statements of Operations for the three and six months ended June 30, 2015 and 2014;
  - (ii) the Consolidated Statements of Comprehensive Income for the three and six months ended June 30, 2015 and 2014;
  - (iii) the Consolidated Balance Sheets as of June 30, 2015 and December 31, 2014;
  - (iv) the Consolidated Statements of Cash Flows for the six months ended June 30, 2015 and 2014;
  - (v) the Consolidated Statements of Changes in Shareholder's Equity for the six months ended June 30, 2015 and 2014; and
  - (vi) the Notes to the Consolidated Financial Statements, tagged in summary and detail.

\* Filed herewith.

\*\* Furnished herewith.

+ Confidential treatment has been requested with respect to certain portions of this exhibit. Omitted portions have been filed separately with the Securities and Exchange Commission.

**SIGNATURES**

Pursuant to the requirements of the Securities Exchange Act of 1934, the registrant has duly caused this report to be signed on its behalf by the undersigned, thereunto duly authorized.

NORWEGIAN CRUISE LINE HOLDINGS LTD.  
(Registrant)

By: /s/ FRANK J. DEL RIO

Name: Frank J. Del Rio

Title: President and Chief Executive Officer  
(Principal Executive Officer)

By: /s/ WENDY A. BECK

Name: Wendy A. Beck

Title: Executive Vice President and Chief Financial  
Officer  
(Principal Financial Officer and Principal  
Accounting Officer)

Dated: August 7, 2015

## NORWEGIAN CRUISE LINE HOLDINGS LTD.

## DIRECTORS' COMPENSATION POLICY

(Effective June 23, 2015)

Directors of Norwegian Cruise Line Holdings Ltd., a company organized under the laws of Bermuda (the "Company"), who are not employed by the Company or one of its subsidiaries or affiliated with Apollo, TPG or Genting HK ("non-affiliated directors") are entitled to the compensation set forth below for their service as a member of the Board of Directors (the "Board") of the Company. The Board has the right to amend this policy from time to time.

<b>Cash Compensation</b>	
Annual Cash Retainer	\$ 100,000
Annual Chairperson Retainer	\$ 25,000
Additional Audit Committee Chair Retainer	\$ 10,000
U.K. Meeting Fee	\$ 10,000
Audit Committee Meeting Fee	\$ 1,200
<b>Equity Compensation</b>	
Annual Equity Award	\$ 50,000
Initial Equity Award	\$ 100,000

**Cash Compensation**

Each non-affiliated director will be entitled to an annual cash retainer while serving on the Board in the amount set forth above (the "Annual Cash Retainer"). A non-affiliated director who serves as the Chairperson of the Board will be entitled to an additional annual cash retainer while serving in that position in the amount set forth above (the "Annual Chairperson Retainer"). A non-affiliated director who serves as the Chair of the Audit Committee will be entitled to an additional annual cash retainer while serving in that position in the amount set forth above (the "Additional Audit Committee Chair Retainer"). A non-affiliated director who attends in person a Board or committee meeting located in the United Kingdom will be entitled to a fee for attendance at the meeting in the amount set forth above (a "U.K. Meeting Fee"), provided that the director will only be entitled to one U.K. Meeting Fee if multiple Board or committee meetings are held on the same day or over consecutive days. A non-affiliated director who serves as a member of the Audit Committee will be entitled to a fee for each Audit Committee meeting attended in person or telephonically, whether located in the United Kingdom or elsewhere, in the amount set forth above (an "Audit Committee Meeting Fee"). Except for the U.K. Meeting Fee and the Audit Committee Meeting Fee, no non-affiliated director will be entitled to a meeting fee for attending in-person or telephonically any other Board or committee meetings.

The amounts of the Annual Cash Retainer and Additional Audit Committee Chair Retainer are expressed as annualized amounts. These retainers will be paid on a quarterly basis, at the end of each quarter in arrears, and will be pro-rated if a non-affiliated director serves (or serves in the corresponding position, as the case may be) for only a portion of the quarter (with the proration based on the number of calendar days in the quarter that the director served as a non-affiliated director or held the particular position, as the case may be). The Annual Chairperson Retainer will be paid in cash in a lump sum each calendar year, by no later than the end of the second quarter of each calendar year. U.K. Meeting Fees and Audit Committee Meeting Fees for attendance at meetings that occur in a particular quarter will be paid at the end of the quarter.

## **Equity Awards**

### *Initial Equity Awards*

For each new non-affiliated director appointed or elected to the Board, on the date that the new non-affiliated director first becomes a member of the Board, the new non-affiliated director will automatically be granted an award of restricted Ordinary Shares of the Company (an "Initial Restricted Share Award") determined by dividing (1) the Initial Equity Award grant value set forth above by (2) the per-share closing price of an Ordinary Share on the date of grant (rounded down to the nearest whole share). Each Initial Restricted Share Award will vest in four substantially equal annual installments on each of the first four anniversaries of the date of grant.

### *Annual Equity Awards for Continuing Board Members*

On the first business day of each calendar year (beginning with the 2015 calendar year), each non-affiliated director then in office will automatically be granted an award of restricted Ordinary Shares of the Company (an "Annual Restricted Share Award") determined by dividing (1) the Annual Equity Award grant value set forth above by (2) the per-share closing price of an Ordinary Share on the first business day of the year (rounded down to the nearest whole share). Each Annual Restricted Share Award will vest in four substantially equal quarterly installments on the last day of each quarter in the applicable calendar year.

For each new non-affiliated director appointed or elected to the Board after the first business day of the year, on the date that the new non-affiliated director first becomes a member of the Board, the new non-affiliated director will automatically be entitled to a pro-rata portion of the Annual Restricted Share Award (a "Pro-Rata Annual Restricted Share Award") determined by dividing (1) a pro-rata portion of the Annual Equity Award grant value set forth above by (2) the per-share closing price of an Ordinary Share on the date the new non-affiliated director first became a member of the Board (rounded down to the nearest whole share). The pro-rata portion of the Annual Equity Award grant value for purposes of a Pro-Rata Annual Restricted Share Award will equal the Annual Equity Award grant value set forth above multiplied by a fraction (not greater than one), the numerator of which is 12 minus the number of whole months that as of the particular grant date had elapsed since the first business day of the year, and the denominator of which is 12. Each Pro-Rata Annual Restricted Share Award will vest in substantially equal quarterly installments on the same schedule as the Annual Restricted Share Award.

### *Elective Grants of Equity Awards*

Non-affiliated directors may elect, prior to the start of each applicable calendar year, to convert all or a portion of their Annual Cash Retainer (but not any Annual Chairperson Retainer, Additional Audit Committee Chair Retainer, U.K. Meeting Fees or Audit Committee Meeting Fees) payable with respect to the particular calendar year into the right to receive an award of restricted Ordinary Shares of the Company (an "Elective Restricted Share Award"). The Elective Restricted Share Award shall automatically be granted on the first business day of each calendar year in an amount determined by dividing (1) the amount of the Annual Cash Retainer elected to be so converted by (2) the per-share closing price of an Ordinary Share on the first business day of the year (rounded down to the nearest whole share). Like the payment schedule for the Annual Cash Retainer, each Elective Restricted Share Award will vest in four substantially equal quarterly installments on the last day of each quarter in the applicable calendar year.

In order to elect to receive an Elective Restricted Share Award, non-affiliated directors must complete an election form in such form as the Board may prescribe from time to time (an "Election Form"), and file such completed form with the Company prior to the start of the applicable calendar year (i.e. if a director wants to convert his or her Annual Cash Retainer payable for the 2015 calendar year, the Election Form must be filed prior to December 31, 2014). Once an Election Form is validly filed with the Company, it shall automatically continue in effect for future calendar years unless the non-affiliated director changes or revokes his or her Election Form prior to the beginning of any such future calendar years.

*Provisions Applicable to All Equity Awards*

Each award of Ordinary Shares will be made under and subject to the terms and conditions of the Company's 2013 Performance Incentive Plan (the "2013 Plan") or any successor equity compensation plan approved by the Company's stockholders and in effect at the time of grant, and will be evidenced by, and subject to the terms and conditions of, an award agreement in the form approved by the Board to evidence such type of grant pursuant to this policy (the "Form of Award Agreement").

**Expense Reimbursement**

All non-affiliated directors will be entitled to reimbursement from the Company for their reasonable travel (including airfare and ground transportation), lodging and meal expenses incident to meetings of the Board or committees thereof or in connection with other Board related business.

[\*]: THE CONFIDENTIAL PORTION HAS BEEN OMITTED PURSUANT TO A REQUEST FOR CONFIDENTIAL TREATMENT AND THE OMITTED MATERIAL HAS BEEN FILED SEPARATELY WITH THE COMMISSION.

Exhibit 10.2

**NINTH AMENDMENT TO LEASE**

(Norwegian Cruise Line – The Landing at MIA)

THIS NINTH AMENDMENT TO LEASE (“Amendment”) is dated effective and for identification purposes as of June 30, 2015 (the “Effective Date”), and is made by and between SPUS7 MIAMI ACC, LP, a Delaware limited partnership (“Landlord”), and NCL (BAHAMAS) LTD., a Bermuda company, d/b/a Norwegian Cruise Line (“Tenant”).

**RECITALS:**

WHEREAS, Landlord’s predecessor-in-interest (Hines REIT Airport Corporate Center LLC) and Tenant entered into that certain Lease Agreement dated December 1, 2006 (“Original Lease”), as amended by that certain First Amendment dated December 1, 2006, Second Amendment dated March 20, 2007, Third Amendment dated July 31, 2007, Letter Agreement dated August 1, 2007, Fourth Amendment dated December 10, 2007, Fifth Amendment dated February 2, 2010, Sixth Amendment dated April 1, 2012, Seventh Amendment dated June 29, 2012, and Eighth Amendment dated January 28, 2015 (collectively, the “Lease”), pertaining to the premises currently comprised of a total of approximately 205,798 rentable square feet of space (of which 125,806 rentable square feet of space are located in 7665 Corporate Center Drive, Miami, Florida (“Building 11”) and 72,925 rentable square feet of space are located in 7650 Corporate Center Drive, Miami, Florida (“Building 10”) (collectively, the “Original Office Premises”), and 7,067 rentable square feet of space are located in 7245 Corporate Center Drive, Miami, Florida (“Building 3”) (“the Warehouse Premises”). Pursuant to the Eighth Amendment, the Original Office Premises was remeasured. Accordingly, as of the Extension Commencement Date (i.e., February 1, 2023), Tenant’s leased rentable square footage will be increased by 5,294 rentable square feet of space in Building 11 and by 2,053 rentable square feet of space in Building 10. Additionally, on January 31, 2023, Tenant’s lease of the Warehouse Premises shall expire. Therefore, as of the Extension Commencement Date, the total rentable square footage for the Original Office Premises shall be 206,078 rentable square feet of space. Further, as of the Expansion Commencement Date, Tenant shall lease from Landlord 65,862 rentable square feet of space located in 7300 Corporate Center Drive, Miami, Florida (“Building 8”) and an additional 4,434 rentable square feet of space in Building 10. The Original Office Premises and Building 8 premises (but not including the Expansion Premises set forth in this Amendment) are collectively referred to herein as the “Total Premises”. Upon the Extension Commencement Date, the Total Premises shall be comprised of approximately 276,374 rentable square feet of space (of which 131,100 rentable square feet of space are located in Building 11, 79,412 rentable square feet of space are located in Building 10, and 65,862 rentable square feet of space are located in Building 8), plus the Expansion Premises set forth in this Amendment; and

WHEREAS, Landlord and Tenant desire to enter into this Amendment to expand the Total Premises and provide for certain other matters as more fully set forth herein;

NOW, THEREFORE, in consideration of the foregoing and the mutual covenants contained herein, the parties agree that the Lease shall be amended in accordance with the terms and conditions set forth below.

1. **Definitions.** The capitalized terms used herein shall have the same definitions as set forth in



the Lease, unless otherwise defined herein.

**2. Expansion.**

( a ) Expansion Premises. The term “Expansion Premises” is hereby defined to be and to mean the majority of the first (1<sup>st</sup>) Floor, in Building 8, consisting of approximately 28,396 total rentable square feet of space (which is the final agreement of the parties and not subject to adjustment), as outlined on Exhibit A, attached hereto and incorporated herein by this reference. The Expansion Premises shall be delivered in the following manner:

<u>Space</u>	<u>RSF</u>	<u>Estimated Delivery Date</u>	<u>Commencement Date</u>
Suites 102 & 112	19,287	The earlier to occur of (i) July 1, 2015, or (ii) the mutual execution of this Amendment.	Four (4) months after the Delivery Date.
Suite 100	4,509	Tenant shall submit to Landlord a preliminary construction schedule with a projected commencement date.*	Four (4) months after the Delivery Date.
Suite 111	4,600	July 1, 2015	November 1, 2015 (i.e., four (4) months after the Delivery Date.

\* Subject to Tenant providing Landlord with a preliminary construction schedule including a projected commencement date for construction of Suite 100, Landlord shall relocate its existing management offices in order to accommodate said schedule.

Promptly following delivery of any portion of the Expansion Premises, the parties shall execute and deliver to one another a Confirmation of Lease Terms and Dates confirming such dates, substantially in the form attached hereto as Exhibit C, each being an “Actual Delivery Date”.

( b ) Expansion Commencement Date. The term “Expansion Commencement Date” with respect to each portion of the Expansion Premises shall mean the date which is four (4) months after Landlord delivers possession of each portion of the Expansion Premises to Tenant. Effective as of each applicable Expansion Commencement Date, the defined term “Leased Premises” under the Lease shall include the Total Premises and the applicable portion of the Expansion Premises, except in accordance with the Eighth Amendment, the expiration date of the Lease Term for the Warehouse Premises shall not be extended by this Amendment and shall remain to expire on January 31, 2023.

(c) Expansion Expiration Date. Tenant’s lease of the Expansion Premises shall expire coterminous with the Lease on January 31, 2028 (“Expansion Expiration Date”).

( d ) Expansion Term. The term “Expansion Term” is hereby defined to be and to mean that period of time commencing on the applicable Expansion Commencement Date and expiring on the Expansion Expiration Date.

(e) Acceptance. Effective on each applicable Expansion Commencement Date,

Landlord hereby leases to Tenant and Tenant hereby leases from Landlord, on the terms and conditions set forth in the Lease and herein, that portion of the Expansion Premises. Tenant shall accept the Expansion Premises in its present “as is” condition as of the Effective Date of this Amendment. Tenant shall install the work set forth in the Work Letter, attached hereto as **Exhibit B** and incorporated herein by this reference.

(f) Notwithstanding anything herein to the contrary, if, in order for Tenant to receive a building permit for Tenant Improvements (as defined in **Exhibit B**) or a certificate of occupancy or completion for the Tenant Improvements, any portion of the existing building systems located outside of and serving any portion of the Expansion Premises or any portion of the existing common areas located on any floors containing any portion of the Expansion Premises are required by applicable governmental authority, to be made compliant with the currently applicable building code or fire code or applicable requirements of the Americans with Disabilities Act (“ADA”), then Landlord agrees that it is Landlord’s responsibility, at its cost, to perform the necessary work to make said portion of the existing building systems and/or existing common areas compliant; however, Tenant acknowledges and agrees that Landlord is only responsible for the building systems up to the point of common connection for the floor on which the applicable portion of the Expansion Premises are located and under no circumstances shall Landlord be required to upgrade restrooms on the first (1<sup>st</sup>) Floor of Building 8 to meet ADA requirements.

3. **Base Rental for the Expansion Premises.** During the Expansion Term, Tenant shall pay to Landlord Base Rental (as defined in Section 2.1 of the Original Lease) for the Expansion Premises in full and without offset or demand except as otherwise set forth in the Lease, provided that such Base Rental shall be payable in monthly installments as follows:

<b>Dates</b>	<b>Annual Rate/RSF*</b>	<b>Monthly Installment</b>
Expansion Commencement Date – 08/31/16*	\$ [*]	\$ [*]*
09/01/16 – 08/31/17	\$ [*]	\$ [*]
09/01/17 – 08/31/18	\$ [*]	\$ [*]
09/01/18 – 08/31/19	\$ [*]	\$ [*]
09/01/19 – 08/31/20	\$ [*]	\$ [*]
09/01/20 – 08/31/21	\$ [*]	\$ [*]
09/01/21 – 08/31/22	\$ [*]	\$ [*]
09/01/22 – 08/31/23	\$ [*]	\$ [*]
09/01/23 – 08/31/24	\$ [*]	\$ [*]
09/01/24 – 08/31/25	\$ [*]	\$ [*]
09/01/25 – 08/31/26	\$ [*]	\$ [*]
09/01/26 – 08/31/27	\$ [*]	\$ [*]
09/01/27 – Expansion Expiration Date (01/31/28)	\$ [*]	\$ [*]

\* The rate per square foot will be applicable to each portion of the Expansion Premises (Suites 102 and 112, 100 and 111); however, the monthly installment will fluctuate based on which portion of the Expansion Premises is included at that time. Each portion of the Expansion Premises shall be entitled to four (4) months of build out time following the applicable Actual Delivery Date, as more fully set forth in Section 2(a) above. Additionally, Tenant shall receive twelve (12) full calendar months of abated Base Rental for each portion of the Expansion Premises, commencing on the applicable Expansion Commencement Date of each portion of the Expansion Premises (i.e., four (4) months following the applicable Actual Delivery Date of each portion of the Expansion Premises). If the applicable Expansion Commencement Date is other than the first day of a calendar month, then the first and last months of the applicable abatement period shall be prorated. Such abatement shall apply solely to payment of the

monthly installments of Base Rental and shall not be applicable to any other charges, expenses or costs payable by Tenant under the Lease or this Amendment, including, without limitation, Tenant's obligation to pay Additional Rental and its utilities. In the event that Tenant defaults under the terms and conditions of the Lease or this Amendment beyond any applicable notice and cure period resulting in the loss of Tenant's right to possess the Premises, Landlord shall have a claim for the unamortized portion of all conditionally abated rental (without limitation and in addition to any and all other rights and remedies available to Landlord provided herein or at law and in equity).

Except as otherwise expressly set forth herein, Base Rental shall be payable pursuant to the terms and conditions of Article 2 of the Original Lease. Tenant shall be solely liable for any and all tax on rental.

4. **Tenant's Percentage Share and Operating Expenses.** Beginning on the Expansion Commencement Date of each applicable portion of the Expansion Premises, Tenant's Percentage Share, as defined in Section 2.3(c) of the Original Lease, shall be increased based upon an amount determined by (a) the fraction, the numerator of which is the total number of Rentable Square Feet then leased by Tenant in Building 8, and the denominator of which is the greater of (i) ninety-five percent (95%) of the total Rentable Square Feet in Building 8; or (ii) the total Rentable Square feet in Building 8 actually leased or occupied by tenants. Operating Expenses for calendar year 2015 are presently estimated to be \$12.01 per rentable square foot of space in the Expansion Premises.

5. **Tenant's Parking Spaces for Building 8.** Tenant shall have the right to use an increased number of parking spaces based on the new rentable area of the Expansion Premises, pursuant to the same terms and conditions as Section 8 of the Eighth Amendment, except that upon on the Expansion Commencement Date, Tenant shall also receive an additional fourteen (14) parking permits for the Building 8 parking garage, at no additional cost to Tenant, as shown on **Exhibit D**, attached hereto and incorporated herein by this reference.

6. **Signs.** Tenant shall have signage rights to the Building 8 Façade Sign and the Building 8 Monument Sign, including the right to install and maintain signage using any, a combination of any, or all of Tenant's and its related companies' brand names including, but not limited to, Norwegian, Oceania, Regent, and any others pursuant to the same terms and conditions of Section 9 of the Eighth Amendment.

7. **Waiver of Previous Options.** Landlord and Tenant hereby acknowledge and agree that Tenant expressly waives the Building 8 right of offer with respect to the fourth (4<sup>th</sup>) Floor of the Building, as more particularly set forth in Section 12(a) of the Eighth Amendment.

8 . **Brokers.** Tenant hereby represents and warrants to Landlord that Tenant has not dealt with any real estate brokers or leasing agents, except Flagler Brokerage and Management Services, LLC, in association with Travers Realty Corporation, d/b/a Travers Cresa, who represent Tenant, and Landlord hereby represents and warrants to Tenant that CBRE, Inc., is the sole real estate broker or leasing agent representing Landlord (collectively, the “Brokers”). Landlord and Tenant hereby agree to indemnify and to hold each other harmless against any loss, expense, or liability with respect to any claims for commissions or brokerage fees arising from or out of any breach of the foregoing representation and warranty. Landlord shall pay all brokerage commissions due to the Brokers pursuant to a separate agreement. Landlord, Tenant and Broker acknowledge and agree that from the sale of the Office Park in October 2014, Landlord has held in escrow [\*]. Landlord shall release said funds held in escrow to Flagler Brokerage and Management Services, LLC and Travers Realty Corporation, d/b/a Travers Cresa within thirty (30) days of the mutual execution of this Amendment.

9 . **Miscellaneous.** With the exception of those matters set forth in this Amendment, Tenant's leasing of the Leased Premises (including the Expansion Premises set forth herein) shall be subject to all terms, covenants and conditions of the Lease. In the event of any express conflict or inconsistency between the terms of this Amendment and the terms of the Lease, the terms of this Amendment shall control and govern. Except as expressly modified by this Amendment, all other terms and conditions of the Lease are hereby ratified and affirmed. This Amendment may be executed in any number of counterparts, and delivery of any counterpart to the other party may occur by electronic or facsimile transmission; each such counterpart shall be deemed an original instrument, but all such counterparts together shall constitute one agreement. An executed Amendment containing the signatures (whether original, faxed or electronic) of all the parties, in any number of counterparts, is binding on the parties. The “Effective Date” of this Amendment will be the date on which the last party shall have executed and delivered a fully executed Amendment to the other party. The parties acknowledge that the Lease is a valid and enforceable agreement and that neither party has any demands, claims (matured or unmatured), losses, rights of set off or deduction asserted or assertable against the other party in any manner relating to the Lease, or arising in connection with the Leased Premises or the Project.

[Remainder of Page Intentionally Left Blank]

IN WITNESS WHEREOF, this Amendment is dated effective as of the date and year first written above.

**WITNESS:**

By: /s/ Diana Parker  
Name: Diana Parker

By: /s/ Richard Bamonte  
Name: Richard Bamonte

By: /s/ Andy Olvera  
Name: Andy Olvera

By: /s/ Lindsay Louie  
Name: Lindsay Louie

**WITNESS:**

By: /s/ Victor M. Gonzalez  
Name: Victor M. Gonzalez

By: /s/ Lincoln M. Vidal  
Name: Lincoln M. Vidal

**LANDLORD:**

SPUS7 MIAMI ACC, LP,  
a Delaware limited partnership

By: /s/ Claudia Walraven  
Name: Claudia Walraven  
Title: Asst. V.P.  
Date: 6.30.15

By: /s/ Mark Zikakis  
Name: Mark Zikakis  
Title: Vice President  
Date: 6.30.15

**TENANT:**

NCL (BAHAMAS) LTD.,  
a Bermuda company, d/b/a Norwegian Cruise Line

By: /s/ Frank Del Rio  
Name: Frank Del Rio  
Title: Chief Executive Officer  
Date: 6/26/15

**CONSENT OF GUARANTOR**

The undersigned Guarantor under the original Guaranty of Lease dated November 27, 2006 (the "Guaranty"), does hereby consent to the foregoing Amendment. Guarantor acknowledges and agrees that the Guaranty is in full force and effect and shall continue to apply to the Lease, as amended by this Amendment.

NCL CORPORATION LTD.,  
a Bermuda company

By: /s/ Frank Del Rio  
Name: Frank Del Rio  
Title: President & CEO

EXHIBIT A  
EXPANSION PREMISES

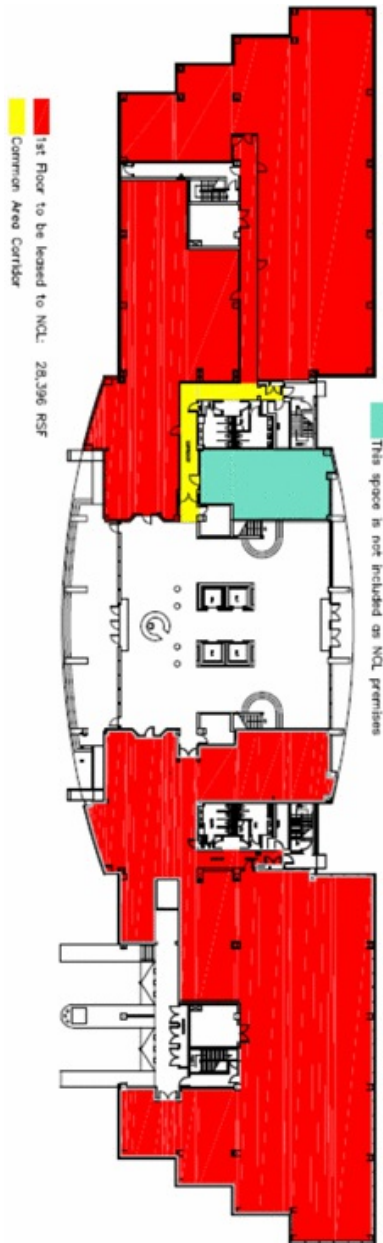

**EXHIBIT B**  
**WORK LETTER**

This is the Work Letter referred to in and specifically made a part of the Amendment to which this **Exhibit B** is annexed, covering the entire Leased Premises, including the Expansion Premises, as more particularly described in the Amendment. Landlord and Tenant agree as follows:

1 . Defined Terms. The following defined terms shall have the meaning set forth below and, unless provided to the contrary herein, the remaining defined terms shall have the meaning set forth in the Lease, as amended:

Landlord's Representative: Suzanne Russo of CBRE, Inc. Landlord has designated Landlord's Representative as its sole representative with respect to the matters set forth in this Work Letter, who shall have full authority and responsibility to act on behalf of Landlord as required in this Work Letter. Landlord shall not change Landlord's Representative except upon prior written notice to Tenant. Tenant acknowledges that neither Tenant's architect nor any contractor engaged by Tenant is Landlord's agent and neither entity has authority to enter into agreements on Landlord's behalf or otherwise bind Landlord.

Tenant's Representative: Victor Gonzalez of Norwegian Cruise Line, or such other person as may be designated in writing by Tenant. Tenant has designated Tenant's Representative as its representative with respect to the matters set forth in this Work Letter, who shall have full authority and responsibility to act on behalf of Tenant as required in this Work Letter. Tenant shall not change Tenant's Representative except upon prior written notice to Landlord.

Allowance: [\*] (i.e., [\*] per rentable square foot of space in the Expansion Premises (the "Tenant Improvement Allowance") to be used for, among other things, permitting, design, construction, interior improvements, cabling and relocation expenses in the Expansion Premises. Up [\*] of the Tenant Improvement Allowance may be used towards Tenant's soft costs (including, but not limited to, furniture fixtures, equipment and Base Rental).

Additional Allowance: An additional [\*] (the "Additional Allowance") may be used for the purchase, use, and maintenance of golf carts and/or Tenant may apply the Additional Allowance towards Tenant's Base Rental obligations. Tenant shall be solely responsible for the purchase, use and maintenance of any golf carts. Any golf carts shall be stored in garage associated with Building 11 after-hours.

Construction Management Fee: None.

General Contractor: City Construction Group (which is hereby approved by Landlord), or such other general contractor approved by Landlord, which approval shall not be unreasonably withheld, conditioned or delayed.

2 . Landlord's Work. Subject to Section 2(e) of the Amendment, Tenant accepts the Expansion Premises in its current "AS IS" condition and acknowledges that Landlord shall have no obligation to do any work in or on the Expansion Premises to render it ready for Tenant's use or occupancy. Landlord will be constructing a lunchroom in Suite 101 of Building 8 (which is not part of the Leased Premises) which shall be accessible to Tenant and shared by other tenants and employees in Building 8. Landlord and Tenant hereby acknowledge and agree that with respect to the west half of the floor, the existing hallway providing access to the Lunchroom and adjacent bathrooms shall remain a common area hallway with full access by all tenants and visitors to the Building. Landlord shall cause to be prepared detailed architectural, mechanical and engineering plans, including all dimensions and specifications for all work to be performed by Landlord in Suite 101. Tenant shall cooperate as necessary regarding Tenant's use of adjoining common areas so as to allow access by Landlord through the common areas to perform Landlord's Work in Suite 101.

3. Tenant Improvements. The "Tenant Improvements" shall mean the interior walls, partitions, doors, door hardware, wall coverings, wall base, counters, lighting fixtures, electrical and telephone wiring, cabling for computers, electrical outlets, ceilings, floor and window coverings, that portion of the HVAC system located within any portion of the Expansion Premises, that portion of the fire sprinklers system located within any portion of the Leased Premises (including the Expansion Premises), and other items of general applicability that Tenant desires to be installed in the interior of the Expansion Premises. Tenant Improvements shall also include the construction of a café on the first (1<sup>st</sup>) Floor of the Expansion Premises. Landlord acknowledges Tenant's intent to design and operate the café solely for use by Tenant's employees and invited guests. Tenant hereby acknowledges and agrees the café will not receive exposure in Building 8's main lobby and the entrance to the café shall be located as shown on attached Exhibit E. With respect to the existing main lobby glass doors and side panels, Tenant hereby acknowledges and agrees that said doors and side panels shall be frosted and shall not be a means of ingress and egress to the café. Tenant shall promptly commence and diligently prosecute to full completion Tenant Improvements in accordance with the Drawings (defined below). Tenant shall have four (4) months from each applicable Delivery Date for construction of the Expansion Premises. The parties agree that no demolition work or other Tenant Improvements shall be commenced within the Expansion Premises until such time as Tenant has provided to Landlord copies of the building permits required to be obtained from all applicable governmental authorities. All materials, work, installations, equipment and decorations of any nature whatsoever brought on or installed in the Expansion Premises before the applicable Expansion Commencement Date or during the Expansion Term shall be at Tenant's risk, and neither Landlord nor any party acting on Landlord's behalf shall be responsible for any damage thereto or loss or destruction thereof due to any reason or cause whatsoever, excluding by reason of Landlord's negligence or willful or criminal misconduct. Notwithstanding anything set forth in this Amendment to the contrary, Tenant shall have the right, in its sole discretion, to apply all or any portion of the Tenant Improvement Allowance to performing Alterations (as defined in and pursuant to Section 5(e) of the Original Lease) to the Expansion Premises.

4 . Drawings. Tenant shall engage and pay for the services of a licensed architect to prepare a space layout, drawings and specifications for all Tenant Improvements (the "Drawings"), which architect shall be subject to Landlord's approval, not to be unreasonably withheld, conditioned or delayed (the



“Architect”). Tenant shall devote such time in consultation with the Architect as shall be necessary to enable the Architect to develop complete and detailed architectural, mechanical and engineering drawings and specifications, as necessary, for the construction of Tenant Improvements, showing thereon all Tenant Improvements. Tenant hereby acknowledges and agrees that it is Tenant's sole and exclusive responsibility to cause the Premises and the Drawings to comply with all applicable laws, including the Americans with Disabilities Act and other ordinances, orders, rules, regulations and requirements of all governmental authorities having jurisdiction thereof.

5 . Landlord's Approval. On or before the applicable Time Limit set forth below, Tenant shall submit to Landlord an electronic PDF copy, electronic CAD copy and hard copy of the complete and final Drawings for Tenant Improvements. The Drawings shall be subject to the approval of Landlord, which approval shall not be unreasonably withheld, conditioned or delayed. If Landlord should disapprove such Drawings, Landlord shall specify to Tenant, in writing, the reasons for its disapproval and Tenant shall cause the same to be revised to meet the Landlord and Tenant's mutual reasonable satisfaction and shall resubmit the same to Landlord, as so revised, on or before the applicable Time Limit set forth below.

6 . Changes. Tenant may request reasonable changes in the Drawings; provided, however, that (a) no change shall be made to the Drawings without Landlord's Representative's prior written approval, which approval shall not be unreasonably withheld, conditioned or delayed; (b) no such request shall effect any structural change in Building 8 or otherwise render any portion of the Expansion Premises or the building within which such portion is situated in violation of applicable laws; (c) Tenant shall pay any additional costs required to implement such change, including, without limitation, architecture and other consultant fees, and increases in construction costs; and (d) such requests shall constitute an agreement by Tenant to any delay in completion caused by Landlord's reviewing, and processing such change. If Tenant requests or causes any change, addition or deletion to the Premises to be necessary after approval of the Drawings, a request for the change shall be submitted to Landlord's Representative, accompanied by revised plans prepared by the Architect, all at Tenant's sole expense.

7 . Tenant's Contractors. It is understood and agreed by the parties that, as hereinafter set forth, Tenant has elected to retain a general contractor and arrange for the construction and installation of Tenant Improvements itself in a good and workmanlike manner by contractors and subcontractors.” On or before the applicable Time Limit set forth below, Tenant shall submit to Landlord the names of the general contractor, electrical, ventilation, plumbing and heating subcontractors (hereinafter “Major Subcontractors”), as applicable, for Landlord's approval, which approval shall not be unreasonably withheld, conditioned or delayed. If Landlord shall reject any Major Subcontractor, Landlord shall advise Tenant, in writing, of the reason(s) and Tenant shall choose another Major Subcontractor. Along with Tenant's notice of its Major Subcontractors, Tenant shall notify Landlord of its estimate of the total costs for Tenant Improvements.

8. Tenant's Construction of Tenant Improvements.

(a) Payment; Liens. Tenant shall promptly pay any and all costs and expenses in connection with or arising out of the performance of Tenant Improvements and shall furnish to Landlord evidence of such payment upon request. In the event any lien is filed against the building within which any Tenant Improvements are performed by Tenant as set forth herein, or against Tenant's leasehold interest therein, the provisions of Article 5(g) of the Original Lease shall apply.

(b) Indemnity. Tenant shall indemnify, defend (with counsel reasonably satisfactory to

Landlord and Tenant) and hold Landlord harmless from and against any and all suits, claims, actions, loss, cost or expense (including claims for workers' compensation, attorneys' fees and costs) based on personal injury, property damage or contract claims (including, but not limited to claims for breach of warranty) arising from Tenant Improvements. Tenant shall repair or replace (or, at Landlord's election, reimburse Landlord for the commercially reasonable cost of repairing or replacing) any portion of the building within which any Tenant Improvements are performed by Tenant as set forth herein, or item of Landlord's equipment or any of Landlord's real or personal property damaged, lost or destroyed by Tenant's contractors during construction of Tenant Improvements.

( c ) Contractors. The Major Subcontractors employed by Tenant and any subcontractors thereof shall be (i) duly licensed in the state in which the Premises are located, and (ii) except as otherwise approved herein, subject to Landlord's prior written approval, which approval shall not be unreasonably withheld, conditioned or delayed. On or before ten (10) business days prior to the commencement of any construction activity in the applicable portion of the Expansion Premises, Tenant and Tenant's contractors shall obtain and provide Landlord with certificates evidencing Workers' Compensation, public liability and property damage insurance in amounts and forms and with companies reasonably satisfactory to Landlord. If Landlord should disapprove such insurance, Landlord shall specify to Tenant the reasons for its disapproval within five (5) business days after delivery of such certificates. Tenant's agreement with its contractors shall require such contractors to provide daily clean up of the construction area to the extent such clean up is necessitated by the construction of Tenant Improvements, and to take reasonable steps to minimize interference with other tenants' use and occupancy of the Building. Nothing contained herein shall make or constitute Tenant as the agent of Landlord. Tenant and Tenant's contractors shall comply with any other reasonable rules, regulations or requirements that Landlord may impose. Notwithstanding anything to the contrary, Tenant's contractors shall not be charged for the use of parking, utilities, elevators use or security costs. To the extent reasonably required by Tenant during construction of Tenant Improvements, Landlord shall use commercially reasonable efforts to provide Tenant with space for a storage container, the exact location and size of which shall be subject to Landlord's reasonable approval and discretion. Tenant shall be responsible to ensure that the storage container satisfies all applicable laws. The storage container may only be used for temporarily storing building materials or equipment which will be incorporated into the Expansion Premises. All of the foregoing shall be maintained by Tenant in a neat and orderly manner and shall not affect other tenants in the Project. Tenant shall be solely responsible for all costs in connection with the foregoing and the same shall only be in place for a reasonable period of time as necessary to facilitate the Tenant Improvements.

( d ) Use of Common Areas. During the construction period and installation of fixtures period, Tenant shall be allowed to use, at no cost to Tenant, a freight elevator for the purpose of hoisting materials, equipment and personnel to the Premises. Also during the construction period, Tenant shall ensure that the Building and all common areas and the Expansion Premises are kept in a clean and safe condition at all times. Further, all construction activities shall be conducted so as to use reasonable efforts to minimize interference with the use and occupancy of the Building by the tenants thereof. Such entry shall be deemed to be under all the terms, covenants, provisions and conditions of the Lease, as amended.

( e ) Coordination. All work performed by Tenant shall be coordinated with Landlord's Representative. Tenant shall use commercially reasonable efforts to timely notify and invite Landlord's Representative to construction meetings (with contractors, engineers, architects and others), and supply all documentation reasonably requested by Landlord's Representative.

(f) Assumption of Risk. All materials, work, installations, equipment and decorations of any nature whatsoever brought on or installed in the Premises pursuant to the provisions of this Work Letter before the commencement of the Term or throughout the Term shall be at Tenant's risk, and neither Landlord nor any party acting on Landlord's behalf shall be responsible for any damage thereto or loss or destruction thereof due to any reason or cause whatsoever, excluding by reason of Landlord or such other party's gross negligence or willful or criminal misconduct.

9. Time Limits. The following maximum time limits and periods shall be allowed for the indicated matters:

<u>Action</u>	<u>Time Limit</u>
Tenant submits Drawings to Landlord for review and approval.	On or before 60 days after the date of mutual execution of this Amendment.
Landlord notifies Tenant and the Architect of its approval of the Drawings with any required changes in detail.	On or before 10 business days after the date of Landlord's receipt of the Drawings.
Tenant notifies Landlord of its selection of major subcontractors.	On or before 60 days after the date of mutual execution of this Amendment.
Landlord approves/disapproves Tenant's major subcontractors.	On or before 7 business days after the date of Landlord's receipt of the list of major subcontractors.
If applicable, Landlord and Tenant mutually approve the final revised list of major subcontractors.	On or before 3 business days after the date of Landlord's receipt of a revised list of major subcontractors.
If applicable, Landlord and Tenant mutually approve the final revised Drawings.	On or before 5 business days after the date of Landlord's receipt of revised Drawings.
Tenant submits Drawings for building permit, if applicable.	On or after the date Tenant and Landlord mutually approve the final, revised Drawings.
Tenant allowed access to the applicable portion of the Expansion Premises to commence Construction of Tenant Improvements	After providing copies of the building permit(s) and the contractors meeting all of Landlord's insurance requirements.

Except as may be otherwise specifically provided for herein, in all instances where either Tenant's or Landlord's approval is required, if no written notice of disapproval is given within the applicable Time Limit, at the end of such period the applicable party shall be deemed to have given its approval and the next succeeding time period shall commence. Any delay in any of the foregoing dates (including any

“re-do”, continuation or abatement of any item due to Tenant's or Landlord's disapproval thereof) shall automatically delay all subsequent deadlines by a like amount of time.

1 0 . Tenant Improvement Allowance. Landlord shall contribute to the costs and expenses of all costs for the planning and design of Tenant Improvements, including all permits, licenses and construction fees and constructing Tenant Work in an amount not to exceed the Tenant Improvement Allowance. If the final costs for Tenant Improvements exceed Tenant Improvement Allowance, Tenant shall be responsible for such excess costs. If the total cost of performing Tenant Improvements is less than the Tenant Improvement Allowance, portions of the Tenant Improvement Allowance may be used towards Tenant's soft costs and existing Lease obligations in accordance with Section 1 of this Work Letter. Landlord shall pay the Tenant Improvement Allowance to Tenant consistent with the terms and conditions of this Section. After Tenant Improvements are complete (as provided under Section 11 hereof), Tenant may submit to Landlord a request in writing (the “Final Draw Request”) for the Tenant Improvement Allowance which request shall include: (a) “as-built” drawings showing all of Tenant Improvements, (b) a detailed breakdown of Tenant's final and total construction costs, together with received invoices showing payment thereof, (c) a certified, written statement from the Architect that all of Tenant Improvements has been completed in accordance with the Drawings, (d) all required AIA forms, supporting final lien waivers, and releases executed by the Architect, General Contractor, the Major Subcontractors and all subcontractors and suppliers in connection with Tenant Improvements, (e) a copy of a certificate of occupancy or amended certificate of occupancy required with respect to the Expansion Premises, if applicable, together with all licenses, certificates, permits and other government authorizations necessary in connection with Tenant Improvements and the operation of Tenant's business from the Expansion Premises, and (f) proof reasonably satisfactory to Landlord that Tenant has complied with all of the conditions set forth in this Work Letter and has satisfactorily completed Tenant Improvements.” Upon Landlord's receipt and approval of the Final Draw Request, Landlord shall pay the balance of the Tenant Improvement Allowance. Payment by Landlord shall be made within thirty (30) days, unless Landlord notifies Tenant, in writing, of its rejection (and the reasons therefor) of any or all of the Final Draw Request. To the extent Landlord does not so reject any portion of said Final Draw Request, Landlord shall timely pay the Final Draw Request. Notwithstanding the foregoing to the contrary, but subject to Section 1 of this Work Letter, Landlord will pay the amount of the Tenant Improvement Allowance to Tenant in progress payments (not more often than monthly) after the applicable Actual Delivery Dates. Such progress payments will be made not later than thirty (30) days after receipt by Landlord from Tenant of copies of Tenant's invoices from its Architect or General Contractor together with a certificate from Tenant indicating that the work to which such invoices relate has been substantially completed and/or the materials to which such invoices relate have been installed in, or delivered to, the applicable portion of the Expansion Premises. Such progress payments will be made payable to Tenant and will be for the undisputed amount of the submitted invoices, less a ten percent (10%) retainage (which shall not be released until such time as Landlord has received the Final Draw Request). As a condition precedent to Landlord's issuing any such progress payment subsequent to the first such progress payment, Tenant will deliver to Landlord an original lien waiver from its general contractor waiving any claim for a mechanic's or materialman's lien with respect to the labor and materials reflected in the invoices submitted for the immediately preceding progress payment.

1 1 . Substantial Completion. Tenant Improvements shall be deemed substantially complete when all work called for by the Drawings has been finished and the applicable portion of the Expansion Premises is ready to be used and occupied by Tenant, even though minor items may remain to be installed, finished or corrected (“Substantial Completion Date” or the “Date of Substantial Completion”). Tenant shall cause the contractors to diligently complete any items of work not completed when the applicable portion

of the Expansion Premises are substantially complete. Substantial completion shall have occurred notwithstanding punch list items. Promptly after the Substantial Completion Date for any portion of the Expansion Premises, the parties will execute an instrument in the form attached hereto as Exhibit C, setting forth the applicable Expansion Commencement Date, so that said date is certain and such instrument, when executed, is hereby made a part of this Amendment and incorporated herein by reference.

12. No Representations or Warranties. Notwithstanding anything to the contrary contained in the Lease, as amended, or herein, Landlord's participation in the preparation of the Drawings, the cost estimates for Tenant and the construction of Tenant Improvements shall not constitute any representation or warranty, express or implied, that (i) the Drawings are in conformity with applicable governmental codes, regulations or rules or (ii) Tenant Improvements, if built in accordance with the Drawings, will be suitable for Tenant's intended purpose. Landlord's obligations shall be to review the Drawings; and any additional cost or expense required for the modification thereof to more adequately meet Tenant's use, whether during or after construction thereof, shall be borne entirely by Tenant.

**[REMAINDER OF PAGE INTENTIONALLY LEFT BLANK]**

**EXHIBIT C**

**CONFIRMATION OF LEASE TERMS AND DATES**

Re: Ninth Amendment to Lease (the "Amendment") dated June 30, 2015, between SPUS7 MIAMI ACC, LP, a Delaware limited partnership ("Landlord"), and NCL (BAHAMAS) LTD., a Bermuda company, d/b/a Norwegian Cruise Line ("Tenant") for the premises located at Building 8, 7300 Corporate Center Drive, Miami, Florida ("Expansion Premises").

The undersigned, as Tenant, hereby confirms as of this \_\_\_\_ day of \_\_\_\_\_, 2015, the following:

1. The Actual Delivery Date of each of the following portions of the Expansion Premises is as follows:

<u>Space</u>	<u>RSF</u>	<u>Actual Delivery Date</u>
Suites 102 and 112	19,287	_____, 2015
Suite 100	4,509	_____, 2015
Suite 111	4,600	_____, 2015

2. The Expiration Date is January 31, 2028.

3. The schedule of Base Rental is:

<u>Dates</u>	<u>Annual Rate/RSF</u>	<u>Monthly Installment</u>
__/__/__ - __/__/__	\$ _____	\$ _____ *
__/__/__ - __/__/__	\$ _____	\$ _____
__/__/__ - __/__/__	\$ _____	\$ _____
__/__/__ - __/__/__	\$ _____	\$ _____
__/__/__ - __/__/__	\$ _____	\$ _____
__/__/__ - __/__/__	\$ _____	\$ _____
__/__/__ - __/__/__	\$ _____	\$ _____
__/__/__ - __/__/__	\$ _____	\$ _____
__/__/__ - __/__/__	\$ _____	\$ _____
__/__/__ - __/__/__	\$ _____	\$ _____
__/__/__ - __/__/__	\$ _____	\$ _____
__/__/__ - __/__/__	\$ _____	\$ _____
__/__/__ - __/__/__	\$ _____	\$ _____
__/__/__ - __/__/__	\$ _____	\$ _____
__/__/__ - __/__/__	\$ _____	\$ _____
__/__/__ - __/__/__	\$ _____	\$ _____
__/__/__ - __/__/__	\$ _____	\$ _____
__/__/__ - 01/31/28	\$ _____	\$ _____

\*Subject to the 12-full calendar month base rental abatement set forth in the Amendment.

4. Tenant has the right to use \_\_\_\_ parking spaces associated with the Expansion Premises. Of which, \_\_\_\_ are located in the covered portion of the parking garage adjacent to Building 8, \_\_\_\_ are uncovered parking spaces in the parking lot associated with Building 8 and \_\_\_\_ are located at \_\_\_\_\_.

5. All alterations and improvements required to be performed by Landlord pursuant to the terms of the Amendment to prepare the Expansion Premises for Tenant's initial occupancy have been satisfactorily completed. There are no offsets or credits against Rent or other amounts owed by Tenant to Landlord, except: \_\_\_\_\_. As of the Effective Date, Landlord has fulfilled all of its obligations under the Lease, as amended. The Lease, as amended, is in full force and effect and has not been modified, altered, or amended. There are no defaults by Landlord.

**TENANT:**  
NCL (BAHAMAS) LTD.,  
a Bermuda company, d/b/a Norwegian Cruise Line

By: \_\_\_\_\_  
Name: \_\_\_\_\_  
Title: \_\_\_\_\_

**EXHIBIT D  
PARKING**

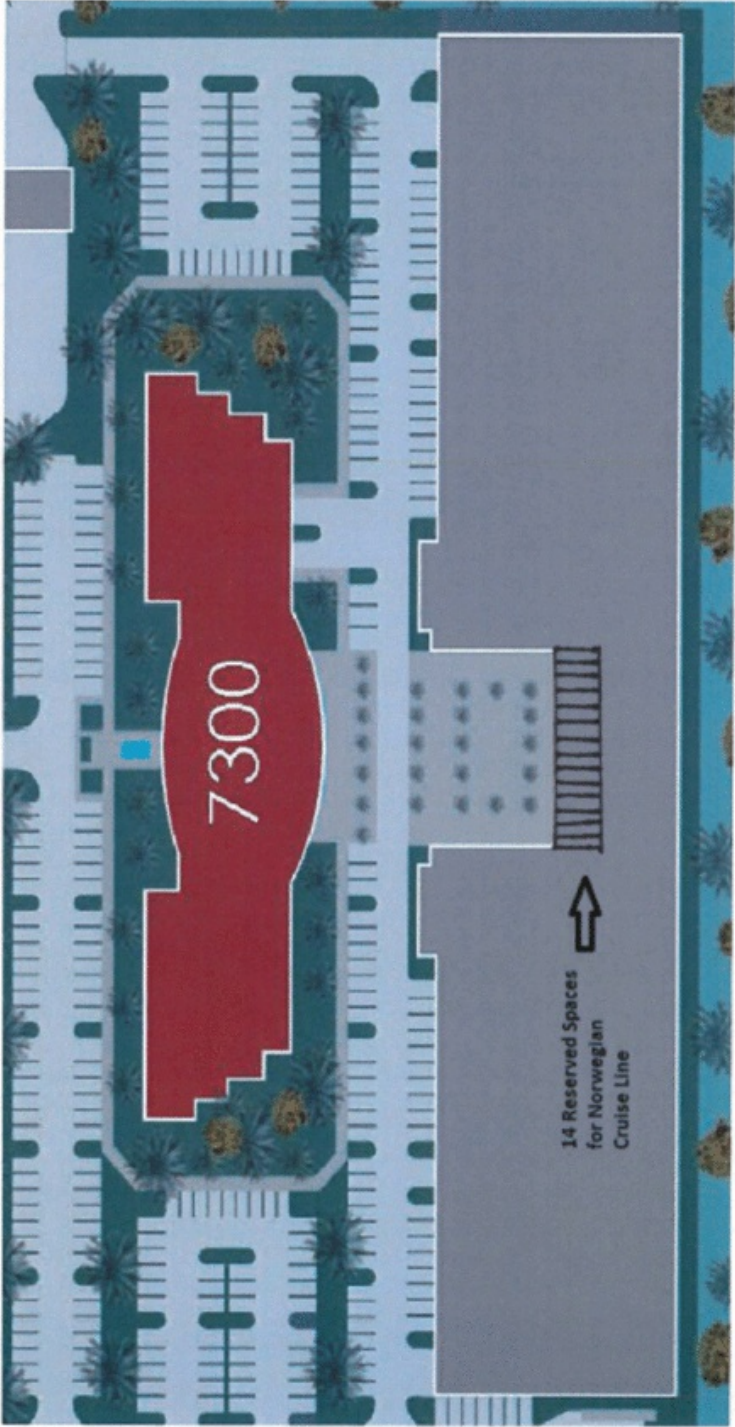



**EXHIBIT E  
LOCATION OF ENTRANCE TO CAFÉ**

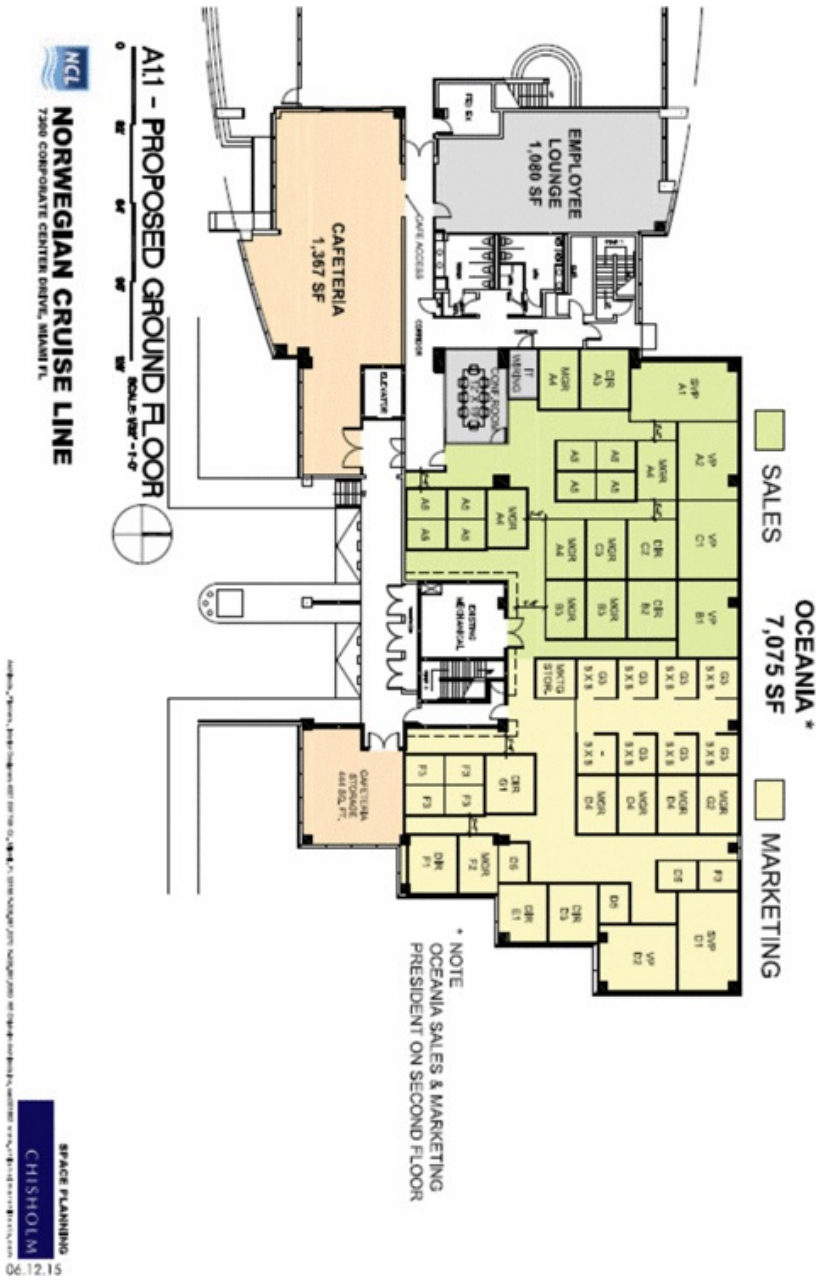

## CERTIFICATION

I, Frank J. Del Rio, certify that:

1. I have reviewed this quarterly report on Form 10-Q of Norwegian Cruise Line Holdings Ltd.;
2. Based on my knowledge, this report does not contain any untrue statement of a material fact or omit to state a material fact necessary to make the statements made, in light of the circumstances under which such statements were made, not misleading with respect to the period covered by this report;
3. Based on my knowledge, the financial statements, and other financial information included in this report, fairly present in all material respects the financial condition, results of operations and cash flows of the registrant as of, and for, the periods presented in this report;
4. The registrant's other certifying officer and I are responsible for establishing and maintaining disclosure controls and procedures (as defined in Exchange Act Rules 13a-15(e) and 15d-15(e)) and internal control over financial reporting (as defined in Exchange Act Rules 13a-15(f) and 15d-15(f)) for the registrant and have:
  - a. Designed such disclosure controls and procedures, or caused such disclosure controls and procedures to be designed under our supervision, to ensure that material information relating to the registrant, including its consolidated subsidiaries, is made known to us by others within those entities, particularly during the period in which this report is being prepared;
  - b. Designed such internal control over financial reporting, or caused such internal control over financial reporting to be designed under our supervision, to provide reasonable assurance regarding the reliability of financial reporting and the preparation of financial statements for external purposes in accordance with generally accepted accounting principles;
  - c. Evaluated the effectiveness of the registrant's disclosure controls and procedures and presented in this report our conclusions about the effectiveness of the disclosure controls and procedures, as of the end of the period covered by this report based on such evaluation; and
  - d. Disclosed in this report any change in the registrant's internal control over financial reporting that occurred during the registrant's most recent fiscal quarter (the registrant's fourth fiscal quarter in the case of an annual report) that has materially affected, or is reasonably likely to materially affect, the registrant's internal control over financial reporting; and
5. The registrant's other certifying officer and I have disclosed, based on our most recent evaluation of internal control over financial reporting, to the registrant's auditors and the audit committee of the registrant's board of directors (or persons performing the equivalent functions):
  - a. All significant deficiencies and material weaknesses in the design or operation of internal control over financial reporting which are reasonably likely to adversely affect the registrant's ability to record, process, summarize and report financial information; and
  - b. Any fraud, whether or not material, that involves management or other employees who have a significant role in the registrant's internal control over financial reporting.

/s/ Frank J. Del Rio

Name: Frank J. Del Rio

Title: President and Chief Executive Officer

Dated: August 7, 2015

---

## CERTIFICATION

I, Wendy A. Beck, certify that:

1. I have reviewed this quarterly report on Form 10-Q of Norwegian Cruise Line Holdings Ltd.;
2. Based on my knowledge, this report does not contain any untrue statement of a material fact or omit to state a material fact necessary to make the statements made, in light of the circumstances under which such statements were made, not misleading with respect to the period covered by this report;
3. Based on my knowledge, the financial statements, and other financial information included in this report, fairly present in all material respects the financial condition, results of operations and cash flows of the registrant as of, and for, the periods presented in this report;
4. The registrant's other certifying officer and I are responsible for establishing and maintaining disclosure controls and procedures (as defined in Exchange Act Rules 13a-15(e) and 15d-15(e)) and internal control over financial reporting (as defined in Exchange Act Rules 13a-15(f) and 15d-15(f)) for the registrant and have:
  - a. Designed such disclosure controls and procedures, or caused such disclosure controls and procedures to be designed under our supervision, to ensure that material information relating to the registrant, including its consolidated subsidiaries, is made known to us by others within those entities, particularly during the period in which this report is being prepared;
  - b. Designed such internal control over financial reporting, or caused such internal control over financial reporting to be designed under our supervision, to provide reasonable assurance regarding the reliability of financial reporting and the preparation of financial statements for external purposes in accordance with generally accepted accounting principles;
  - c. Evaluated the effectiveness of the registrant's disclosure controls and procedures and presented in this report our conclusions about the effectiveness of the disclosure controls and procedures, as of the end of the period covered by this report based on such evaluation; and
  - d. Disclosed in this report any change in the registrant's internal control over financial reporting that occurred during the registrant's most recent fiscal quarter (the registrant's fourth fiscal quarter in the case of an annual report) that has materially affected, or is reasonably likely to materially affect, the registrant's internal control over financial reporting; and
5. The registrant's other certifying officer and I have disclosed, based on our most recent evaluation of internal control over financial reporting, to the registrant's auditors and the audit committee of the registrant's board of directors (or persons performing the equivalent functions):
  - a. All significant deficiencies and material weaknesses in the design or operation of internal control over financial reporting which are reasonably likely to adversely affect the registrant's ability to record, process, summarize and report financial information; and
  - b. Any fraud, whether or not material, that involves management or other employees who have a significant role in the registrant's internal control over financial reporting.

/s/ Wendy A. Beck

Name: Wendy A. Beck

Title: Executive Vice President and Chief Financial Officer

Dated: August 7, 2015

---

**CERTIFICATIONS OF CHIEF EXECUTIVE OFFICER AND CHIEF FINANCIAL OFFICER PURSUANT TO 18 U.S.C. SECTION 1350 AS ADOPTED PURSUANT TO SECTION 906 OF THE SARBANES-OXLEY ACT OF 2002**

Pursuant to 18 U.S.C. Section 1350, as adopted pursuant to Section 906 of the Sarbanes-Oxley Act of 2002, each of Frank J. Del Rio, the President and Chief Executive Officer, and Wendy A. Beck, the Executive Vice President and Chief Financial Officer, of Norwegian Cruise Line Holdings Ltd. (the "Company"), does hereby certify, that, to such officer's knowledge:

The Quarterly Report on Form 10-Q of the Company, for the quarter ended June 30, 2015 (the "Form 10-Q"), fully complies with the requirements of Section 13(a) or 15(d) of the Securities Exchange Act of 1934 and information contained in the Form 10-Q fairly presents, in all material respects, the financial condition and results of operations of the Company.

Dated: August 7, 2015

By: /s/ Frank J. Del Rio  
Name: Frank J. Del Rio  
Title: President and Chief Executive Officer

By: /s/ Wendy A. Beck  
Name: Wendy A. Beck  
Title: Executive Vice President and Chief Financial Officer

---

